



28

SITE VISIT RECORD SHEET

HIGHLAND REGIONAL COUNCIL ARCHAEOLOGY SECTION

NT 01 SW 0020

SITE NAME: Abbeystead Birch Wood	SMR: 01371449
SITE TYPE: Probable corn Kiln	NGR: 26.65 N of 9 29.37 W of 9
LEGAL STATUS:	ACCESS:
NAME/ADDRESS * (OWNER/TENANT)	
REASON FOR VISIT:	OFFICER/DATE: Pat Allan 15/9/95
DESCRIPTION, NOTES, COMMENTS: Largely destroyed kiln, possibly corn 3m internal diameter. Flue 50cm wide, 360° NW, 2.3m width of kiln wall. N/W side heavily destroyed. Total Diameter of Kiln 6.9m (line?) Tumble mainly to S/W. Length 10m 20, N/S, in total, including tumble. Max height internally 70cm	
FURTHER ACTION:	WEATHER/CONDITIONS: Covered with bracken, heather grasses + fallen birch trees
PHOTOGRAPHS/DRAWINGS:	SKETCH OVERLEAF: *YES/NO

Cumint land use: unused

26.65

Station 9

0184/1446

1446
3

0134

0134
3

2.3
3
6.9

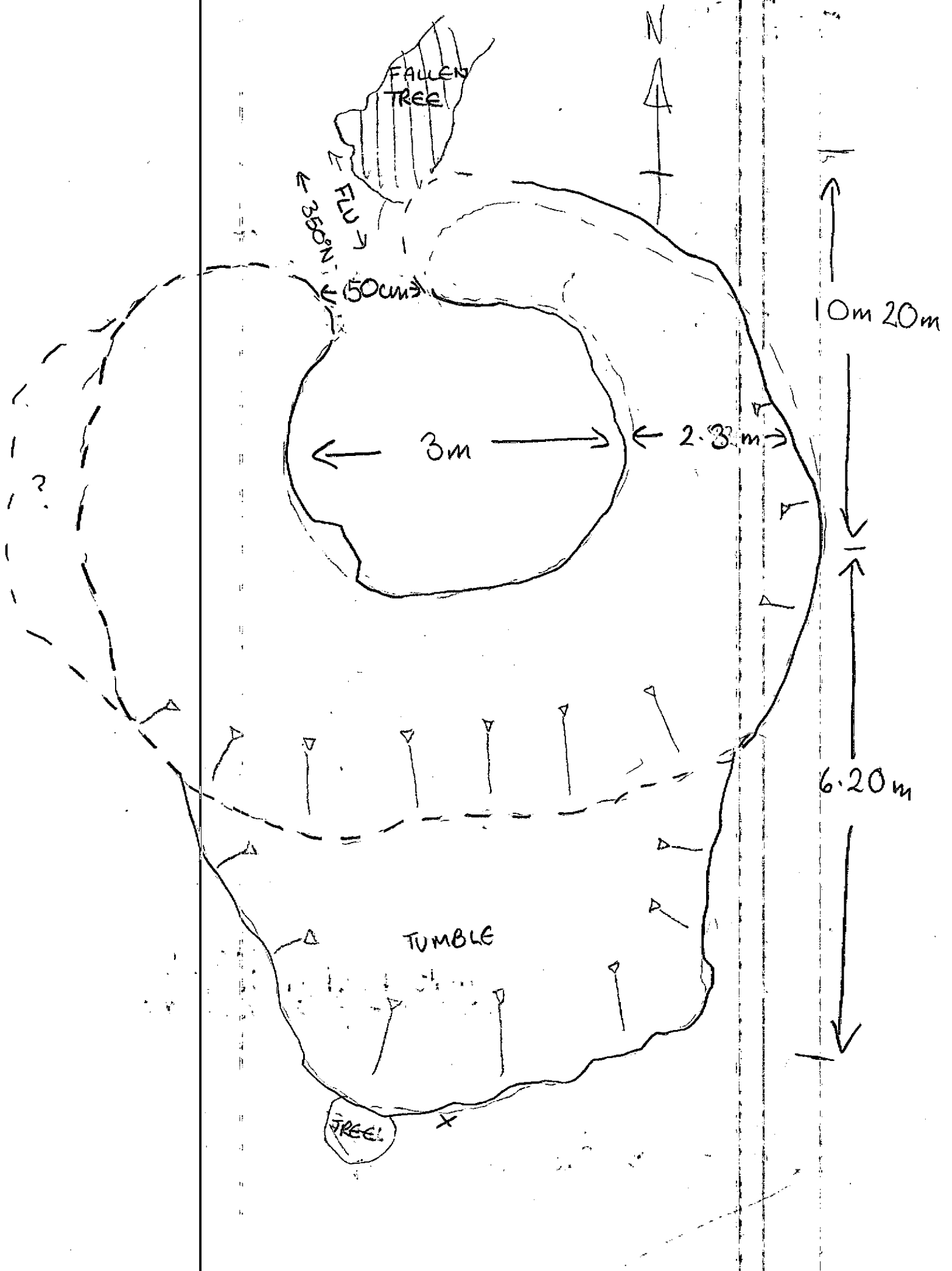

Current land use : unwooded

28 30 28
30

SITE VISIT RECORD SHEET

Station 9

HIGHLAND REGIONAL COUNCIL ARCHAEOLOGY SECTION

SITE NAME: Rynettin birch wood		SMR: NS 01 SW 0020
SITE TYPE: corner of building		NGR: 60713614431 17 21.00 1451
LEGAL STATUS:	ACCESS:	
NAME/ADDRESS * (OWNER/TENANT)		
REASON FOR VISIT:	OFFICER/DATE:	
DESCRIPTION, NOTES, COMMENTS: Foundation of drystone structure, possibly a bothy, obscured by fallen trees and bracken but with well-defined edges. 9.40m N/S on long axis, 4.40m E/W, 2.8m thick & 1 c. 60cm high in places		
FURTHER ACTION:	WEATHER/CONDITIONS: Dense cover of bracken + fallen trees	
PHOTOGRAPHS/DRAWINGS:	SKETCH OVERLEAF: *YES/NO	

69.7 N
17.81 E

1446
17
53

0134
2
0136

1443
17
1450

Cement laid in: unused

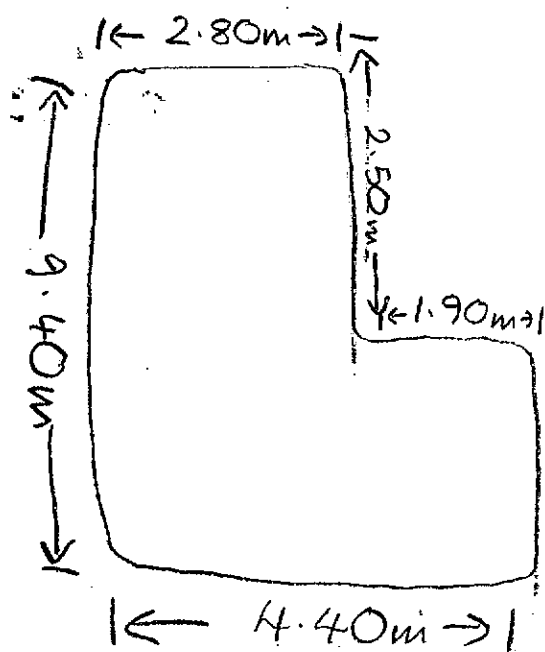

SITE VISIT RECORD SHEET

HIGHLAND REGIONAL COUNCIL ARCHAEOLOGY SECTION

NT01SW 0020

SITE NAME: <i>Rynellin Birch Wood</i>	SMR: <i>01371449</i>
SITE TYPE: <i>Impossible to interpret due to mature vegetation</i>	NGR: <i>26 80 N of (g)</i> <i>25 90 NE of (g)</i>
LEGAL STATUS:	ACCESS:
NAME/ADDRESS * (OWNER/TENANT)	
REASON FOR VISIT:	OFFICER/DATE: <i>Pat Allan</i> <i>15/9/95</i>
DESCRIPTION, NOTES, COMMENTS: <div style="display: flex; justify-content: space-between;"> <div style="width: 60%;"> <p>(A) Nearest to kiln, \uparrow Fin length s/w (200°) \downarrow 2.20m narrowest 5.20m midpoint</p> <p>(B) 2nd from kiln \downarrow 10.3m length s/w (216°) \uparrow 3.75m narrowest 3.80m midpoint</p> <p>(C) 3rd from kiln \downarrow 0.7m length s/w (220°)</p> </div> <div style="width: 35%; font-size: 2em;">}</div> <div style="width: 5%;"> <p>Parallel to each other</p> </div> </div> <p>Across top of 3 rows lies stretch of 14.4m (155° s/w)</p> <p>Several large dressed stones amongst general tumble - no evidence of mortar</p> <p>NB. Presence of elder and rowan and fold clearance, including dressed stone.</p>	
FURTHER ACTION:	WEATHER/CONDITIONS: <i>Excessive moss/fern etc.</i> <i>Overgrown</i>
PHOTOGRAPHS/DRAWINGS:	SKETCH OVERLEAF: *YES/NO

0134
3
1446
3

7
5.20
3.75
9.0

Does not follow the contours of the slope, ~~but~~ altho' is at the base of a change in slope

25-90
26-80 S Current land use - unwooded

Bowdoin Hall

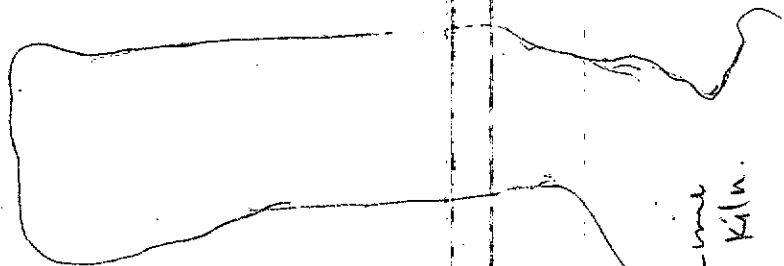
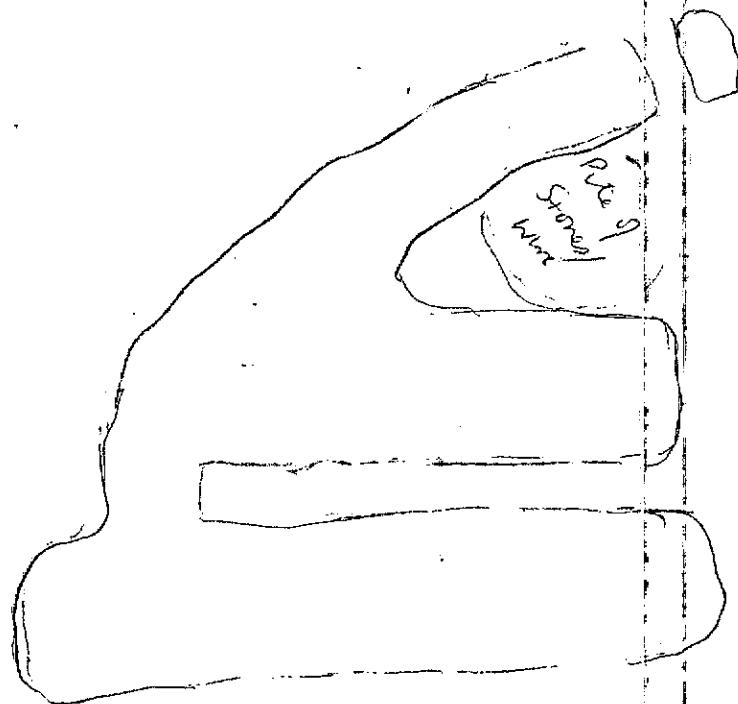

SITE NO: 28
SITE NAME: RYNETTIN BIRCH WOOD
SITE TYPE: CORN KILN
NGR: NJ 0137 1449

The remains of a circular stone-built structure, probably a corn-drying kiln with a total diameter of 6.9m, and an internal diameter of 3m. The west side of the feature remains clear but the north and east sides are obscured by tumble, either from associated features or from more recent clearance. The stones facing the interior, although obscured by vegetation, seem in good repair and are dressed. The flue opening is at 350° NW and is approximately 0.5m wide but its length is obscured by a large fallen tree. The total length of the feature, including tumble is 10.2m N/S and the maximum height internally is 0.7m.

RECOMMENDATIONS: Removal of the fallen trees and further investigation.

(Not illustrated)

SITE NO: 29
SITE NAME: RYNETTIN BIRCH WOOD
SITE TYPE: STONE SPREAD
NGR: NJ 0135 1450

This is a flat, elliptical stone spread, 11m E/W in diameter and 16.5m N/S. It comprises a platform of unworked medium stone, either the result of field clearance, or the mutilated remains of a prehistoric cairn.

RECOMMENDATIONS: Maintain site as open ground with regular grazing / cutting of scrub regrowth. Avoid ground disturbance.

(Not illustrated)

SITE NO: 30
SITE NAME: RYNETTIN BIRCH WOOD
SITE TYPE: CORNER OF BUILDING FOUNDATION
NGR: NJ 0136 1451

The foundation of drystone structure, possibly a bothy. The structure is obscured by fallen trees and bracken but appears to have well-defined edges. It measures 9.4m N/S on its long axis and 4.4m E/W. The wall and associated tumble is 2.8m thick. There is a turn to the east 2.5m internally, with a short continuation of the feature 1.9m east.

RECOMMENDATIONS: Clear trees and maintain site as open ground. Avoid ground disturbance.

(Not illustrated)

SITE NO: 31
SITE NAME: RYNETTIN BIRCH WOOD
SITE TYPE: STONE LINES
NGR: NJ 0137 1449

This feature was virtually obscured by mature vegetation cover but appears to consist of 3 interconnected lines of stone situated 3m to the north of a gap in the main field boundary. The full width of the feature is 14.4m (155°sw). The three elements are roughly parallel and connected at the south. The easternmost line is 7m in length, running 200° SW. It is 5.2m from the second stone line which lies to its west. This line is 10.3m in length and runs at 216°SW. The third line of stones is slightly curved and is 9.7m in length, running at 220°SW. It is 3.8m to the west, uphill from its neighbour.

The feature does not follow the contours of the natural slope, although it lies at the base of a change in slope. It consists of general amorphous tumble, although there are several large dressed stones amongst them, and the internal edge of the second line may have been faced. It was impossible to interpret this feature, in part due to the vegetation but also due to the presence of recent dumps of field walling material, including fencing wire. Its proximity to the kiln, 1 m to the east suggests settlement activity.

RECOMMENDATIONS: Clear trees and maintain site as open ground. Avoid ground disturbance. Further investigation would be advisable.

(Not illustrated)