



Highland Archaeology Services Ltd

Bringing the Past and Future Together

Auchtertipper



Archaeological Survey

7 Duke Street Cromarty Ross-shire IV11 8YH

Tel / Fax: 01381 600491 Mobile: 07834 693378 Email: info@hi-arch.co.uk Web: www.hi-arch.co.uk

Registered in Scotland no. 262144 Registered Office: 10 Knockbreck Street, Tain, Ross-shire IV19 1BJ VAT No. GB 838 7358 80

Independently Accredited for Health and Safety, Environment and Quality Control by UVDB Verify



Auchtertipper

Archaeological Survey

Report No.	HAS101007
Project Code	HAS-ACT10
Client	Cawdor Estate
Planning Ref	N/A
NGR (approx centre)	NH 9238 2785
OASIS	highland4-85666
Date/ revision	03/11/2020
Authors	John Wombell and John Wood

Summary

A rapid walk-over survey was carried out ahead of a tree-planting scheme at Auchtertipper, Cawdor. A large number of archaeological sites and features was recorded: these were all of medieval or post-medieval date.

Acknowledgements

Fieldwork was carried out by Lachlan McKeggie and John Wombell. We wish to thank Cawdor Estate's Hugh McLaren for commissioning this survey and Stan Thomson for his invaluable advice and assistance. We are also grateful to George Grant for the benefit of his local knowledge. Modern Ordnance Survey mapping is reproduced by permission of Landmark Information Group under Licence 100043217. Historic maps are courtesy of the National Library of Scotland.

Contents

Site Location.....	4
Introduction	5
Policy Background	6
Methodology	7
Desk-based assessment.....	7
Walkover Survey	8
Results	9
Conclusions	22
Recommendations	23
References	24
APPENDIX 1: Index of Archaeological sites recorded during fieldwork.....	39
APPENDIX 2: Index of Photographs.....	52

Illustrations

Figure 1 Site location.....	4
Figure 2 Survey Area.....	6
Figure 3 Extract from Roy's Map 1747-55.....	7
Figure 4 Extract from 1st edition OS 6 inch map	8
Figure 5 Auchtertipper sites LM2, JW5, JW6	25
Figure 6 Auchtertipper sites LM3, LM4.....	26
Figure 7 Auchtertipper Sites LM1, LM5, JW3, JW7.....	27
Figure 8 Auchtertipper site JW5; Ess sites LM7, LM10	28
Figure 9 Ess site LM11	29
Figure 10 Ess site LM12; Auchterteang sites LM13, JW12, JW13	30
Figure 11 Rysaurie sites LM24, LM26.....	31
Figure 12 Rysaurie sites LM23, LM28, JW9	32
Figure 13 Rysaurie sites LM16, LM17, LM21	33
Figure 14 Rysaurie sites LM19, LM20.....	34
Figure 15 Auchterteang sites LM15, LM27; Rysaurie site LM18.....	35
Figure 16 Badenargit sites LM31, JW15	36
Figure 17 Lyndeor sites JW23, JW17, JW18.....	37
Figure 18 Lyndeor sites JW16, JW19, JW20, JW21, JW22,	38
Figure 19 Site locations – Auchterteang and Lyndeor.....	47
Figure 20 Site locations – Auchterteang north.....	48
Figure 21 Site locations - Auchtertipper	49
Figure 22 Site locations – Rysaurie / Lyndeor (detail)	50
Figure 23 Linear features.....	51
Figure 24 Photo locations (N).....	59
Figure 25 Photo locations (S)	60
Figure 26 Photo locations – Rysaurie / Lyndeor (detail)	61
Plate 1 Aerial view of Auchterteang.....	10
Plate 2 Auchterteang: Enclosure (Site LM15).....	10
Plate 3 Aerial view of Auchtertipper	13
Plate 4 Corn-drying kiln (Site JW3)	13
Plate 5 Badenargit longhouse Site LM31	15
Plate 6 Aerial view of Ess.....	17
Plate 7 Ess: Sheiling hut, site LM11	17
Plate 8 Aerial view of Lyndeor.....	19
Plate 9 Aerial view of Rysaurie	21
Plate 10 Mill lade (Site LM22)	22

Site Location

The survey area covers 682 hectares or thereby, within the Cairngorms National Park on the Inverness-shire / Nairnshire border. It is centred approximately at OS grid reference NH 9238 2785. See Figures 1 and 2 below.



Figure 1 Site location

Introduction

An archaeological walkover survey was conducted in October 2010 in advance of a new woodland creation scheme under the Scottish Rural Development Programme (SRDP).

The area surveyed is the upper two thirds of the valley of the Duthil Burn, running north – south. The east side of the survey area is bounded by the B9007 public road linking Duthil and Forres, whilst the western boundary lies against a block of commercial woodland to the south and the lower slopes of Creag na h-Lolaire to the north. The north boundary contours round the lower slopes below Carn Mheadhoin and Carn na Leitire. To the south the boundary is that with the farm of Lochgorm.

The maximum height above sea level within the survey area is at the north end, c420m, and the lowest is c250m at the south. The survey area is characterised by a pattern of both regularly and unevenly shaped late 18th and 19th C improved fields and associated farmstead buildings on the valley floor and the adjacent sloping terraces. Undulating and gently rising heather dominated moorland contains the improved ground, with narrow bands of birch dominated woodland surviving on the lower reaches of the several watercourses which run down to the Duthil Burn. The survey team understands¹ that no heather has been burnt in the survey area for the past 10 years. Whilst the best of the improved fields are in very good shape and clearly being well managed for both pasture and conservation, much of the valley floor has always been poorly drained, and earlier pasture fields enclosed by ditches and turf and stone walls are reverting back to wetland, despite extensive mechanical ditching.

Structures survive to varying degrees, from the faintest remains of footings to fully upstanding buildings with roofs. With the exception of the farmhouse at Auchterteang and its main building, which are still occupied and are outwith this survey, all other buildings in the survey area are in a state of slow decline and natural decay. A number of farmstead buildings appear to be in occasional use, and whilst some buildings have closed doors, livestock is generally free to roam in and out of many of them.

A key feature of much of the survey area above the valley floor, on the rolling moraine terraces with eskers, mounds, hummocks, and occasional kettle holes, is that the surface is pocked by thousands of small humps and hollows, circular or oval in shape, sometimes more elongated, ranging from 1m across to 3m or more across. This phenomenon is most notable on the improved heather free middle grazing which has not been cultivated. These may be of periglacial origin or tree throw pits from a long time ago. Where erosion over time has levelled some of these features out, they can appear frustratingly as if the hand of man might have been involved, but natural hummocks and dips like this are quite common in the Highlands. The numerous man made storage pits identified near all of the farmsteads are quite distinctive and different to these natural features.

Although the farmsteads at Auchterteang, Lyndeor and Rysaurie are excluded from planting in the scheme the boundary around them was unclear so we have tried to include as much as possible within the survey.

¹ Stan Thomson, personal communication

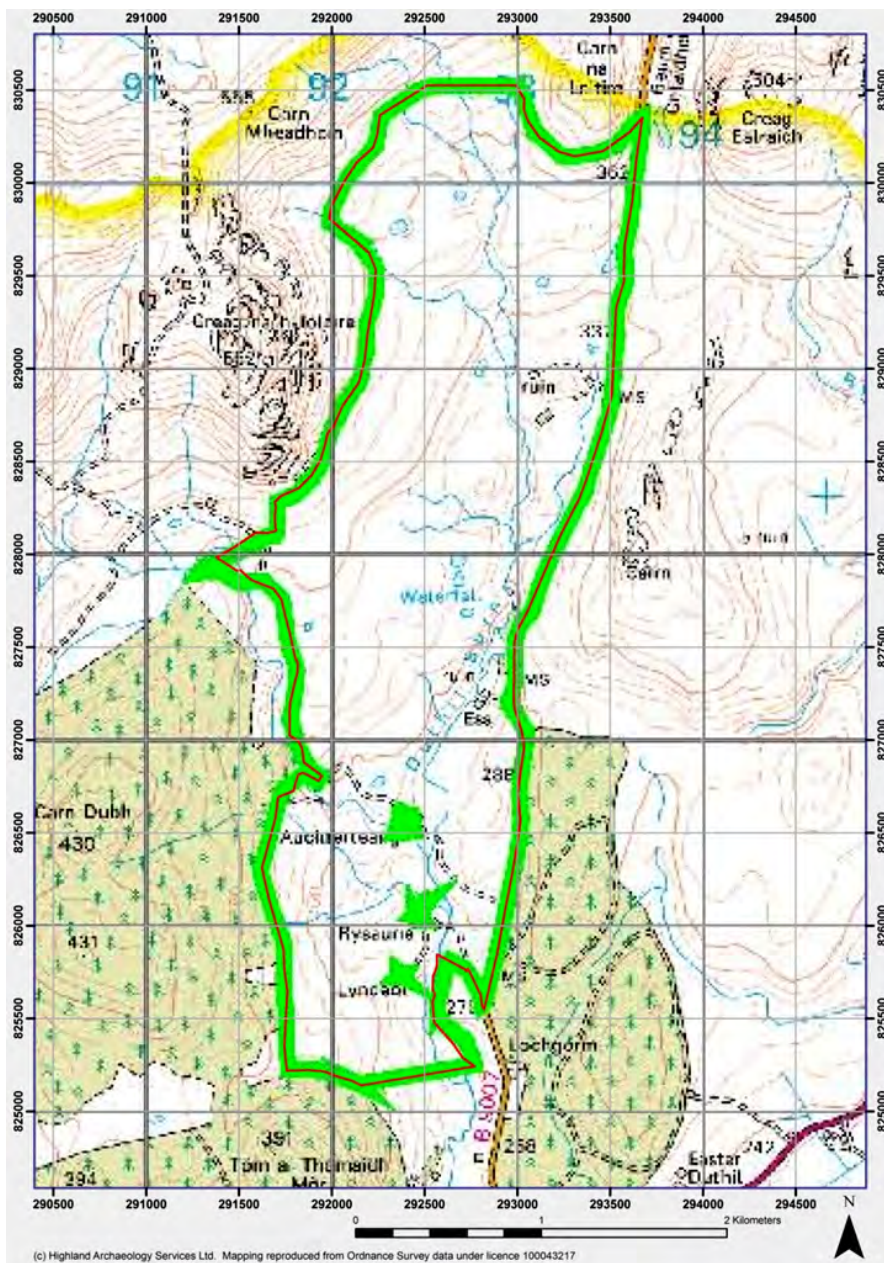

Figure 2 Survey Area

Policy Background

The Scottish Government's *Scotland Rural Development Plan* (SRDP) is a programme of economic, environmental and social measures, worth some £1.5 billion, designed to develop rural Scotland from 2007 to 2013. Individuals and groups may seek support to help deliver the Government's strategic objectives in rural Scotland. It covers all aspects of rural land management, including forestry²

It is the responsibility of land managers in receipt of grant under the scheme need to ensure as far as possible that archaeological sites and historic buildings (the historic environment) should not be damaged by changes in land management. This survey was commissioned to provide baseline information on any cultural heritage features that might be impacted by the planting scheme.

² <http://www.scotland.gov.uk/Topics/farmingrural/SRDP>

Methodology

Desk-based assessment

A desk-based assessment was conducted in order to assess the archaeological potential of the area based on previously recorded sites and any historical documentation.

A check was made of all relevant records from the Highland Historic Environment Record (HHER), National Monuments Record of Scotland (NMRS), Highland Council Archives and Historic Scotland's records of scheduled monuments and listed buildings. Online aerial photographs and historical maps were checked for any relevant site information. The rapid walk-over survey of part of this area carried out by Jonathan Wordsworth in 1996-7 was consulted³.

The Statistical Accounts of Scotland were checked online. The National Library of Scotland online collection of historic maps was also checked including the First Edition Ordnance Survey 1:10560 scale maps. Aerial photographs were checked online at *Where's the Path?*⁴.

It is notable that very little is shown in this area on the early maps.



Figure 3 Extract from Roy's Map 1747-55

Roy, William. *Military Survey of Scotland, 1747-1755*. See <http://geo.nls.uk/roy-highlands/>

³ Wordsworth J 1997 *Archaeological Survey of a Proposed Native Pinewood at Auchterteang, Cawdor Estate* (HHER EHG9; Report no. 10465)

⁴ <http://wtp2.appspot.com/wheresthepath.htm>



Figure 4 Extract from 1st edition OS 6 inch map
Inverness-shire (Mainland) Sheet XXXIV - surveyed 1868-71

Walkover Survey

The survey was undertaken over 7 working days between Monday October 11th 2010, and Wednesday 20th October 2010. The weather conditions were good for the time of year. Light showers occurred on two afternoons. Only on the final day of field work was visibility temporarily impeded, when heavy snow showers set in around lunchtime. On that particular day the survey team was glad of the comfort of the Garrocher Lunching Hut in which to have lunch.

Each individual feature was recorded using hand-held GPS offering a typical accuracy of 5m. Selected features were also sketched in the field. A total of 79 features of archaeological interest were recorded as individual sites in the survey area plus one just outside it – the Garrocher Lunching Hut (Site JW40). 113 digital photographs were taken, and 39 measured drawings were made. Details of each feature are given in under the names of the six townships in the survey area.

Results

From the north the townships are: Auchtertipper, Ess, Auchterteang, Badenargit, Rysaurie, and Lyndeor. Only Badenargit does not appear as a name on the current OS 1:10,000 map. That name was acquired from the 1st Edition OS map dating to around 1870. They are listed here in alphabetical order.

AUCHTERTEANG

Sites

LM13 A ruined lime kiln at NH 92544 26507, much robbed and eroded by livestock, cut into the S side of a moraine bank, has a large work area below and the possible remains of an oval stance a few m away to the W. See scale drawing (Fig 11) and photo PJ49.

LM14 At NH 92349 26465 are the stone footings of a building on a terrace above the main building on the S side of the Garrocher Burn, c9m N/S x 2m internally. Wall footings c0.7m wide stand to 0.5m max in ht. See scale drawing and photo PL1.

LM15 A substantial but ruined enclosure c17m E/W x 12m internally, at NH 92318 26581, walls of stone and turf, spread to c2m, stand to 1.3m on the N side, entrance on the S side. Several compartments within the enclosure, interpretation unclear. May have been an enclosure with wooden huts inside, may also have been a kail yard at some time as there are 2 large storage pits just outwith the enclosure on the S side. See scale drawing (Fig 16) and photos PL2 and PL3.

LM27 A group of storage pits (Fig 16)

JW12 The low turf covered footings of a probable turf walled building at NH 92410 26463, truncated by a modern fence, measures c7m E/w x 3m internal, wall spreads up to 3m, c0.4m high, no obvious entrance. See scale drawing (Fig 11) and photo PJ50.

JW13 A similar smaller building near to JW12, at NH 92413 26455, measures c3m E/W x 2m internally, clear entrance on S side, stone lined pit of c1.5m diameter close by. See scale drawing (Fig 11) and photo PJ51.

JW48 Substantial stone walled enclosure shown on the 1st Ed OS, measures c30m NE/SW x 20m internally with an entrance to the NE, at NH 92402 26505. See photo PJ53.

JW49 Nissen hut on earlier stance

Discussion

Four buildings are shown as roofed on the 1st Ed OS, but because the tracks at Auchterteang have been re-aligned and the farmhouse and main farm buildings are let and out of the survey area, only an incomplete picture of the settlement here has been obtained. Several much older turf walled structures were identified, one truncated by a modern fence. An enclosure on the edge of the moor shown on the 1st Ed OS appears to have been a kail yard, but it is some distance from today's buildings.

A ruined lime kiln was identified. No shielings were identified. A second substantial enclosure below the occupied farmhouse may also have been a kail yard or a later kitchen garden.

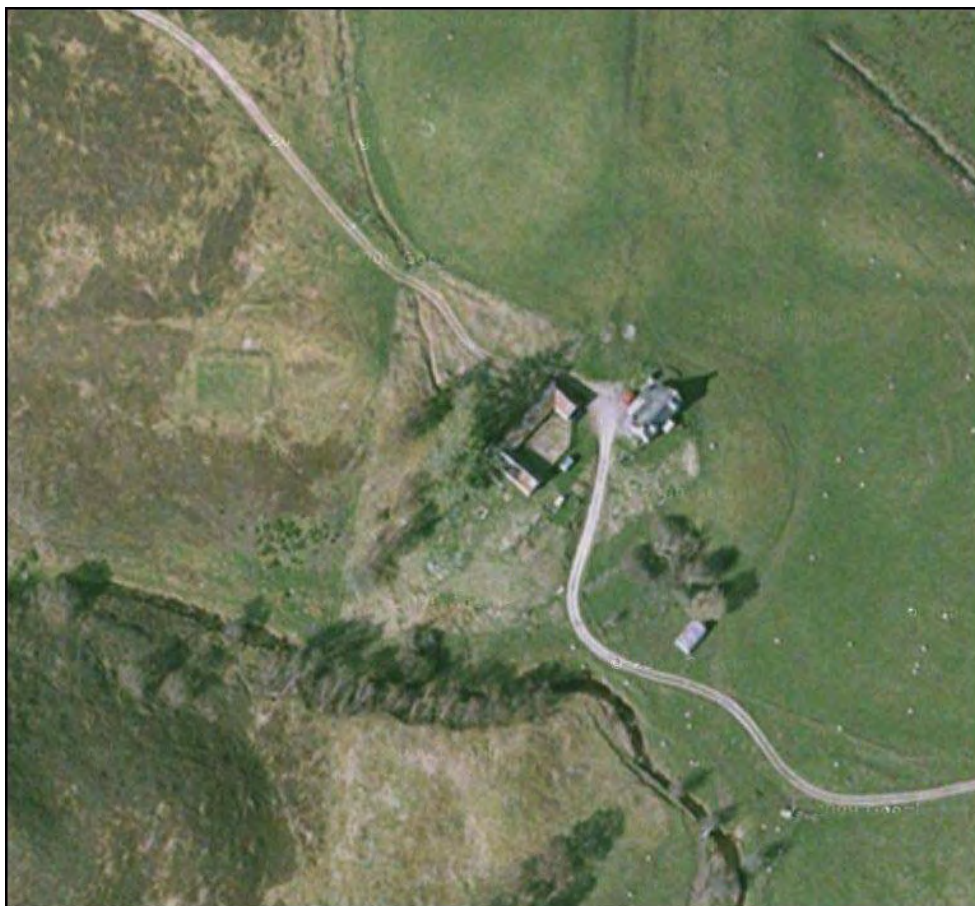

Plate 1 Aerial view of Auchterteang
(*Google Maps*)



Plate 2 Auchterteang: Enclosure (Site LM15)

AUCHTERTIPPER

Sites

LM1 Sub-rectangular shieling hut, on a small haugh, regularly flooded, close to the burn at NH 92955 29016, 8m NW/SE x 2.75m internal, round corners inside and out, entrance in SE corner. Walls spread to c1.5m, standing 0.3m high max. All heather covered, just a few wall stones showing. The north gable has been protected from flooding by a 'V' shaped piece of walling, of which only the double faced cobble footings remain, c 0.75m wide. See scale drawing (Fig 8) and photos PJ12 and PJ13.

LM2 The heather covered footings of a sub rectangular building, probably a turf walled long-house, at NH 92975 28941, 14m NW/SE x 2.5m internal. A small compartment shows to the SW. Wall spread to 2m, but to 3m with considerable battered under-building at SW. Wall height to c. 0.3m, corners rounded inside and out. 2 entrances in SE side wall. See scale drawing (Fig 6) and photo PJ14.

LM3 A complex, 'L' shaped range of utility farm buildings, at NH 93040 28980 plus a yard, depicted roofed on the 1st Ed OS, plus an attached yard. Walls much tumbled, all of drystone construction, double faced, standing to c 1.5m high max. Several divisions can be seen and signs of alteration over time. The longest leg of the complex measures 22m NE/SW x 3m internal. A modern fence truncates the leg extending SW. See scale drawing and photo PJ18.

LM4 A group of storage pits, at NH 93023 28944. See scale drawing (Fig 7) and photo PJ15.

LM5 The horse shoe shaped remains of a once substantial lime kiln, at NH 93352 28878, cut into SE face of a moraine mound. Dry stone walls c1.2m thick show 3 courses at the back of the kiln, but all of the front wall including the lintels, has been robbed out. The drop from the top of the kiln to the rake out floor is c2m. Turf covered loading ramp c2m long still visible above the back rim of the kiln. See scale drawing (Fig 8) and photos PJ23 and PJ24.

LM6 Sample grouse butt, at NH 91900 30043, No 9 in that line, just above the NW limit of the survey area. Key hole in plan, c1.5m diam with an entrance passage c2.5m long, and .45m wide. The wooden peg with a '9' carved into it survives alongside. See photo PJ29 of the butt and PJ30 of the numbered peg.

JW1 A small enclosure adjoining the large enclosed southern field in its SE corner, centred on: NH 92937 28076. Sub rectangular, 10m SW/NE x 9m internal. S and E sides are heather covered earth banks, N and W sides are cuts into the natural moraine bank above. Also a small external platform on E side adjoins this enclosure, triangular in shape. Photo No. PJ3

JW2 Enclosure shown on the 1st Ed OS, inside the SW corner of the southern enclosed field, rectangular, centred on: NH 92868 28188, 17m NW/SE x 14m internal. Formed by heather covered earth banks. Photos PJ5 and PJ6.

JW3 Corn drying kiln with barn attached, centred on NH 92653 28567, sits c 1Km SW of the nearest cultivated field. Well preserved kiln bowl has a diam of 2.5m at rim ht. Low stone footings protrude from a sea of rank heather. The site sits above a small lochan, and it is reached from the farmstead by a well constructed track which continues on past the kiln site for another 100m or so terminating at a natural hollow containing 4 small winter ponds. Approx 50m N of the kiln at NH 92627 26589 a strong spring arises, with the flow then passes close to the kiln. The kiln, its barn and natural resources suggest that this was an illicit whisky production site, with all process taking place hereabouts, as no still bothy could be found elsewhere on Auchtertipper ground. See scale drawing (Fig 8) and photos PJ9, PJ10 and PJ11.

JW4 Group of storage pits centred on: NH 93050 28940. See Photo No. PJ15.

JW5 Roofless late 19C or early 20thC farmhouse, centred on NH 93074 28968, measures 14m E/W x 4.4m internal. Was one and a half storeys, lime mortar construction, dressed quoins, fireplaces ground and upper floors in W gable, E gable fallen. See scale drawing (Figs 6,9) and photos PJ18, PJ19, PJ21.

JW6 Turf walled longhouse centred on: NH 93080 29000, sub rect. c13m NE/SW x3m internal, wall spread to c2m, max ht 0.3m, rounded corners inside and out. Possible small compartment at SW end. No obvious entrance. See scale drawing (Fig 6) and photo PJ22.

JW7 Corn drying kiln with barn attached and probable stack yard alongside centred on: NH 93004 28935. Kiln bowl is infilled, c2.5m diameter at rim, kiln and barn together measure 9m NE/SW x 3m internal. Single central flue, blocked up with stones. Entrance in SE side wall. Walls double faced drystone, stones dressed to fit, stand to 1m max, 0.75m wide. Most of wall tops and interior covered with fine turf. The attached stack yard is a raised platform, with entrance to N, but no enclosing walls or fence remain. No evidence of stack bases – whole area covered in fine turf. See scale drawing (Fig 8) and photos PJ17 and PJ20.

JW8 Possible dished mound, oval c4m N/S x 3m (internal), at NH 93150 28401.

JW31 2 stone filled pits, one is c3m x 2m at and the other is c2m x 1.5m at NH 93212 28450. No photo.

JW32 Sample grouse butt at NH 91806 27296, in a line running N/S on the W boundary of the survey area. Half circle in shape, 2.5m wide, walls 1.5m wide, 1.4m deep, stone faced. See photo LM 48

JW33 Sample grouse butt at NH 91701 28311. Key hole in plan, mostly turf construction, low down internal stone facing. See photo PL51.

JW35 Group of 4 winter ponds at NH 92635 28530, at the end of a track which serves the corn / malt drying kiln on the moor. No photo.

JW36 Kettle hole ponds below farmhouse, as depicted on the 1st Ed OS, enhanced by linked ditches, with a shallow sub-rectangular pond at the lower end being purpose dug, possibly for flax retting. Centred on NH 93090 28930.

JW45 The track from the west side of the cultivated ground leading out to the corn / malt drying kiln on the moor, runs from approx NH 92980 28680, to the winter ponds at NH 92635 28530, in more or less a straight line.

JW50 Section of old road marked on the 1st Ed OS running NE from NH 9326 29040 at Auchtertipper farmstead to the public road (B9007) at NH 93547 29388. Covered in rank heather, disused for a long time, but originally well constructed. About 2m average width.

Discussion

At Auchtertipper 3 buildings are shown roofed on the 1st Ed OS, and none unroofed.

In the survey 21 archaeological features are attributed to Auchtertipper, approx half in a cluster forming the farmstead, with others, including a single sample from each line of disused grouse butts, stretching out onto the moorland. The dwelling house as drawn on the 1st Ed OS was some 36m in overall length, whilst today the now roofless farmhouse is just 16m in overall length, with some 10m of smaller earlier footing visible beyond the E gable. This suggests that the standing remains of the ruined farmhouse today were built after the 1st Ed OS was surveyed, and that its predecessor on the same site was a traditional long house. The fine but flood wasted remains of a family sized sheiling hut lay close to the burn below the farmstead, whilst on the ridge where the farmstead sits are the remains of two long houses, quite probably of different periods, and other features most likely of turf wall construction.

The lime kiln at Auchtertipper is reasonably well preserved, the best in the survey area, but all of the lintels and most of the front wall have been robbed out.



Plate 3 Aerial view of Auchtertipper
(Google Maps)

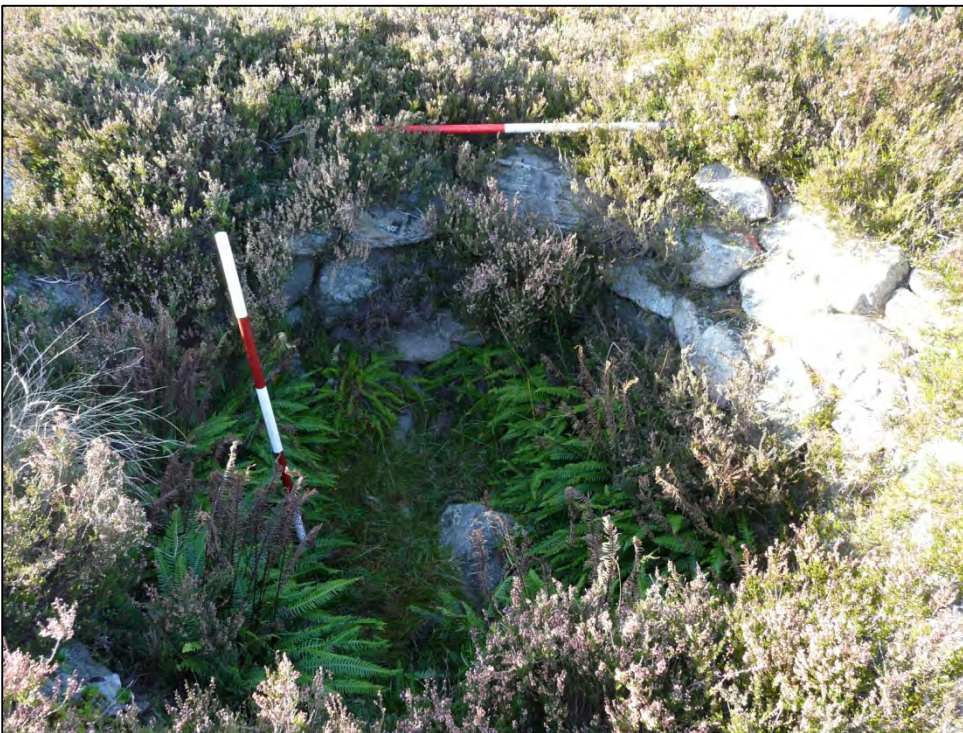

Plate 4 Corn-drying kiln (Site JW3)

Of particular interest is the corn drying kiln at Auchtertipper which lies c. 1 km away from the farmstead and fields out on the rough heather moorland. It survives in an exceptional state of preservation, complete with kiln barn attached and hints of a possible structure over the fire and flue. Approx 50m above the kiln there

risers a strong spring of clean water, whilst below the site is a small lochan. A well defined track leads to this kiln and continues c100m beyond it to a hollow with 4 small saucer shaped 'winter' ponds around it, all with smooth turf bottoms. The only reason which comes to mind for this elaborate isolated set-up is illicit whisky production. No whisky bothy could be found beside any of the burns at Auchtertipper and it appears that all the whisky production processes were taking place at this one location. The ponds and their banks would have been used for steeping and germinating, the kiln for drying the malt, the spring was the water supply and the whisky was distilled in the attached barn. The site can be seen from the farmstead through a gap in a low moraine ridge, but not from anywhere else.

BADENARGIT

Sites

LM30 A sub-rectangular cut feature c.3m N/S x 2m internally, and 0.4m deep, cut into a small mound at NH 91161 25899, near the foot of a ditch. See photo PL24.

LM31 Building No1, a possible long house, shown roofed on the 1st Ed OS, at NH 91938 26324, measures 16m E/W x 3m internally. Stone footings, spread to 2m in places, remain to c. 0.3m in height. All covered in deep heather or turf. See scale drawing and photo PL26. Building 2, is smaller of a similar nature, at NH 91958 26334, measures 5m N/S x 3m internally. Walls spread to c. 1m, remain to c. 0.4m high. See scale drawing (Fig 17) and photo PL27.

JW15 Badenargit East, the stone footings of a very wasted 'L' shaped building shown roofed on the 1st Ed OS, at NH 92183 26260. Single course only remains of the double faced walls, built of large stones. See scale drawing and photo PJ57. A footpath runs direct from this structure over dry ground towards the Rysaurie hill gate.

JW10 A small enclosure or pen at NH 91905 25970, 10m N/S x 8m internally, walls boulders and turf, spread to 3m wide, standing to 0.5m max. This abuts the ditch and bank which enclose a large regular shaped field of the better ground at Badenargit. See photo PJ55.

JW11 A substantial enclosure at Badenargit West, at NH 91900 26325, c. 20m square, shown on the 1st Ed OS 1:10560 map, beside the buildings. Substantial walls of boulders, stones and turf. See photo PL25.

JW44 The well formed path which links Badenargit West from NH 91950 26310 and Badenargit East at NH 92921 26260, shown clearly on the 1st Ed OS remains extant. No photo.

Discussion

There are two parts to Badenargit which we have called 'East' and 'West', some 200m apart and connected by a well built path exactly as shown on the 1st Ed OS.

The third building of Badenargit West shown on the 1st Ed OS almost certainly exists where shown on that map but the survey team was unable to locate it in the deep heather. Another footpath runs east from Badenargit East in a direct line to the Rysaurie hill gate.

The enclosure shown as part of Badenargit West on the 1st Ed OS is still a dominant feature on the ground and lies immediately west of that group of buildings.

Of note is the great length the inhabitants of Badenargit went to, to enclose some very poor ground with ditches and turf walls. They also enhanced by deeper digging a number of natural water courses in order to dry up and improve small areas of ground. The improved areas of ground as shown on the 1st Ed OS still stand out today as more fertile islands in a sea of rank heather.



Plate 5 Badenargit longhouse Site LM31

ESS

Sites

LM7 The wasted remains of a lime kiln at NH 92883 27204. Horse shoe shaped, much robbed. Internal length of the horse shoe c4m. Large work area below. Faces SW. See scale drawing (Fig 9) and photo PJ36

LM8 A possible lime kiln represented as a cut bowl with work area below, at: NH 92886 27193, close to the more definite kiln LM7. See photo PJ37.

LM 9 A small enclosure on a sloping bank at NH 92922 27248, 25m x 11m internally, which truncates the good revetted path from the lime kiln. On 3 sides the enclosure is formed by substantial ditch and banks, on the 4th N side how the enclosure was closed is unclear. Photo PJ34 shows the enclosure in the distance whilst PJ35 was taken from within it of the group of nearby pits LM10. The track between this enclosure and the lime kiln may have continued to link with the path to the double enclosure JW7 at one time.

LM10 A group of 6 storage pits on a dry bank at NH 92894 27252. See scale drawing (Fig 9) and photo PJ35.

LM11 A substantial stone and lime building with barn attached at NH 92786 27186, to form an 'L' shape in plan, with fenced yard to rear. The building has undergone various alterations and changes over time. Walls c. 0.5m wide, wall head 1.8m. It has some interesting internal features and numerous period artefacts remain in the building some of which were photographed. See scale drawing (Fig 10) and photos PJ38, PJ39, PJ40, PJ47, PJ44, PJ45, PJ46, PJ41, PJ42 and PJ43.

LM12 The poor remains of one or more stone and lime buildings, at NH 92817 27242, on a substantial stance. The only part retained has been patched to create a temporary pen. The remainder appears to have been bulldozed. See scale drawing and photo PJ48.

JW14 Section of old well built road, survives to c. 2.3m wide in places, leaves the line of public road above Ess Falls, at NH 93066 27735 heading N to reach the SE corner of the large walled field at Auchtertipper, at NH 93017 28054. It crosses the Allt a Ghuaill at NH 93027 28045.

JW29 A dam above Ess falls at NH 92950 27811, c. 7m long, with a drop of c. 1m on the downside, constructed of round poles c. 200mm diameter, bolted vertically to each other and horizontally to vertical 75mm x 75 mm square posts. The purpose of the dam appears to have been recreational, either for swimming or fishing. Today the pool above is completely filled with gravel. See photos 42 and 43.

JW30 Sample of an unlined grouse butt in the line extending above Ess falls across the B9007 road. See photo PL44.

JW34 A derelict footbridge constructed using 2 lengths of narrow gauge rails, at NH 92572 28110. See photo PL55.

JW39 A well constructed disused probable shooters path leaves the public road above Ess falls and heads off over the rough moorland more or less in a straight line, crossing the Duthil Burn by a derelict footbridge identical to JW34, to become indistinct above the second footbridge (JW34) not far from a line of grouse butts. The footbridge over the Duthil Burn is at NH 92932 27921. At NH 93006 27879 there is a choice of routes either heading straight up to the B9007 or following the river side path S to Ess farmstead.

JW46 A revetted track running c. 100m from LM9 enclosure to the lime kiln LM7. See photo PJ34.

JW47 A double enclosure shown on the 1st Ed OS on a narrow terrace above the E bank of Duthill Burn, now covered with mature birch trees. A narrow path comes and goes between the small enclosure LM9 and this double enclosure, then continues a short distance with remains of a turf wall on the lower side a short distance down to the river at approx NH 92923 27468.

Discussion

At Ess 4 buildings are shown roofed on the 1st Ed OS and none unroofed. Today there is no evidence whatsoever of two of the buildings, on an area of ground which has been used for many years as a feeding stance. The area where the buildings stood appears to have been swept clean by machine. These missing buildings are likely to have been of timber construction. A substantial stone and lime building still roofed appears to have undergone several alterations and changes of use, and a barn has been added at a later date to form an 'L' shape. The barn is interesting in that under the corrugated iron cladding peaty turfs have been used as insulation on one side, supported on 'backs', whilst on the other side heather has been used for the same purpose, laid horizontally.

The only other building at Ess is very ruinous and again we suspect the use of a machine to flatten all but one corner with a lean-to against it, possibly a kitchen or scullery at one time, which was retained as a pen.

On the steep bank below the public road at Ess a well built track from the ruined lime kiln crosses the access track to Ess then ends abruptly against a small ditch and bank enclosure whose extent is unclear. This small enclosure may possibly have been a later potato patch, truncating the track which possibly continued to the double enclosure shown clearly of the 1st Ed OS some 200m to the north, built on a small terrace on the same steep bank. The enclosures remain extant today but are covered in mature birch trees. From the car parking area and track leading to Ess Farmstead a footpath runs north to the picturesque Ess falls, where a wooden dam has been built above the falls apparently to create a pool for recreational purposes, though today it is choked with gravel.



Plate 6 Aerial view of Ess
(*Google Maps*)



Plate 7 Ess: Sheiling hut, site LM11

LYNDEOR

Sites

JW16 The stone footings of a building at NH 92348 25394, measure 13m E/W x 3m internally. Double faced walls now spread to c. 2m. Entrance in S side. Wasted and indistinct around E gable end. Another possible building exists as low footings c. 5m N/S x 3m internally 4m SW of JW16, close to the hydro electric pole. See scale drawing (Fig 19) and photo PJ56.

JW17 A sub rectangular building at NH 92292 25711, badly truncated by the bulldozed track alongside, would have measured c. 7m E/W x 3m internally. Some stone work still remains, turf and rush covered. To the immediate NE lies a circular feature c 3.5m internal diameter, walls spread to c. 2m. See scale drawing (Fig 18) and photo PL34.

JW18 A roofed building is shown on the 1st Ed OS at this stance at NH 92350 25704, now swept away. Just enough of the footings remain to suggest a lime mortar building c. 13m NE/SW x 3.5m internally. See scale drawing (Fig 18) and photo PL36.

JW19 A wooden bothy with hen house and hen run attached, at NH 92358 25717. See scale drawing (Fig 19) and photo PL37.

JW20 A modern timber garage set into the remains of an earlier stone and lime building, at NH 92345 25720, which was cut into the natural bank behind. See scale drawing (Fig 19) and photo PL38

JW21 An early 20th house, of lime mortar and stone construction with later bathroom and store added to the front, at NH 92360 25725. See scale drawing (Fig 19) and photo PL39.

JW22 A stone walled structure cut into a steep bank at NH 92321 25638. Much slumping of stones and earth within. A second feature attached has been truncated by a track. See scale drawing (Fig 19) and photo PL35.

JW23 An enclosure about 10m square, with semi circular feature attached at NH 92340 25651. S and E walls turf and stone N and W walls revetted into the natural slopes. See scale drawing (Fig 18) and photo PL24.

JW24 A group of storage pits and an oval stance at approx. NH 92463 25833. See photo PL40.

JW25 A group of storage pits at approx. NH 92513 25886. See photo PL41.

JW27 Two circular pits clearly man made, E of the river near the track which forms the boundary of the survey area, at NH 92663 25072, cut into a moraine mound, today filled with water. No photo.

JW28 Two possible graves at NH 92704 25343, on E side of river dug in the top of a dry mound, also near to the boundary track. One measures 1.8m E/W x .06m N/S and the other 1.2m E/W x 0.6m. N/S See photo PJ58.

JW41 A section of well built old road linking Lochgorm to Lyndeor and Rysaurie is shown clearly on the 1st Ed OS and that part within the survey area, forming also the E boundary of the survey area to a certain extent, remains extant. Not surveyed.

Discussion

There are no remaining farm buildings at Lyndeor. What would appear to have been a sizeable long house of probable stone and lime construction was swept away in the past, most likely when the present farmhouse was built on a new site a little to the north. There are the remains of two older buildings up on the edge of the moor one to the west and one to the south. Neither are likely to have been shielings as they are not near a good water supply.



Plate 8 Aerial view of Lyndeor
(Google Maps)

RYSAURIE

Sites

LM16 A very ruinous lime kiln at NH 92509 25991, set into a S facing bank. Very little left other than a horse shoe shaped depression. There is a 2m vertical drop from loading point to working floor, which has been truncated over time by ploughing of the adjacent field. See scale drawing (Fig 14) and photo PL4.

LM17 A substantial high quality timber built range, 'L' shaped in plan with stalls for 5 horses, 2 loose boxes and a barn with neap store attached, at NH 92463 26023. A date inscribed on one internal door is 1903. Two later lean-to poor quality timber additions added, one now dilapidated and the second also poor. The building sits on a dwarf wall c300mm wide and 300mm deep of lime mortared stones. The frame of the main and older building almost entirely of 150mm x 62mm Scots pine, apart from the main corner posts which are 150mm square. Vertical studs at 800mm centres. Dwangs 95mm x 35mm at 750mm vertically. Roof clad with corrugated iron, hip ends, galvanised iron gutters, 5 CI skylights. Outer cladding - vertical boards with weather overlap. See scale drawing (Fig 14) and photos PL13, PL14, PL17, PL28, PL29.

LM 18 A lime mortared, stone sided mill lade with the undercroft of a possible late horizontal mill at its lower end. The end of the undercroft is at NH 29401 26032, beginning of undercroft NH 92398 26030, top of the stone lade NH 92391 26022. The last remains of what is likely to have been the bottom rail of a timber mill house lie adjacent to one of 4 x18mm diameter bolts set into the top of the stone undercroft. The undercroft is filled with stones, earth and scrap iron – a bicycle frame, buckets and oil drums etc. At the top of the stone work the lade turns 90 degrees to the S and from there to the mill pond (LM22) the substantial

lade is unlined. At NH 92383 25939 the remains of a 150mm diameter post marks the possible position of a sluice gate. It ends well into the pond at NH 92374 25929. See scale drawing (Fig 16) and photos PL15, PL16, PL18 and PL19.

LM 19 A ruinous walled enclosure, shown on the 1st Ed OS, centred on NH 92484 26045, with possibly 2 buildings attached likely to have turf walled. The enclosure measures 19m E / W x 14m internally. The larger attached building measures 10m N/S x 3m internally, with a possible entrance in the NE. Probably originally a kail yard, later a kitchen garden worked in 3 terraced plots. See scale drawing (Fig 15) and photos PL5 and PL6.

LM20 The turf covered footings of a likely turf walled building centred on NH 92525 26043, truncated by the present vehicle track to the farmhouse. Wall spreads to c1.5m, ht c0.3m. Hook shaped outshot in the SE corner. Probable ditch to N side. See scale drawing (Fig 15) and photo PL7.

LM21 Small turf walled building at NH 92525 26063, c3m E/W x 1m internal. See scale drawing (Fig 14) and photo PL8.

LM22 Mill dam and pond, centred on NH 92353 25925. The earth dam is c4m wide at base, flat top c1m wide, and slightly 'S' shaped. Depth c. 1m max, total length 40m. The pond which today is completely dry with a fine turf bottom is c 55m E/W x 28m with a narrow arm of 30m to the NW. The ditch / lade feeding the pond enters the pond at approx 15m W of the S end of the dam.

LM23 Modern farmhouse, stone and lime construction, 1.5 storeys with flat topped dormers, one collapsed in, at NH 92472 26091. This building is rapidly falling derelict. Chimneys in both gables. See scale drawing (Fig 13) and photo PL10.

LM24 Two storage pits at NH 92456 26111. See scale drawing (Fig 12) and photo PL12.

LM25 A hard stance, with remains of stone kerbing c10 m to the W of the farmhouse at approx. NH 92456 26077. See photo PL11.

LM26 Group of 9 storage pits on a mound, at NH 92481 26065. See scale drawing (Fig 12) and photo PL9.

LM27 Group of 3 storage pits in the face of the bank behind the timber range, at NH 92430 26051. The largest pit likely to be for neaps. See scale drawing and photo PL13.

LM28 The scant heather covered footings of a shieling hut, at NH 92252 26004, 7m N/S x 2.5m internally. Possible pen attached to the S with a separate dairy c 2m x 1m internally, to the N, close a small un-named burn. A few stones show through the heather and turf. See scale drawing (Fig 13) and photo PL22.

LM29 Oval feature cut into N facing slope of a moraine mound, at NH 92157 25900, c2m x 1.5m internally, may be part of the shieling group in this area. See photo PL23.

JW9 The scant heather covered footings of a substantial sub-rectangular shieling hut, at NH 92217 25946, close to a small un-named burn, c12m N/S x 3m internal. Max wall spread of stones c1m. Entrance in SE corner. Part of E side wall missing. Small dairy c3.5m NW/SE x 1.5m with entrance to SE lies c6 N of the main structure and may an enhanced natural feature. See scale drawing (Fig 13) and photo PJ54.

JW26 A single square shaped storage pit at NH 92533 25866, c2m x 2m. No photo.

JW37 A small weir constructed of boulders, 2 courses visible, with a water level drop of c 0.5m, formed the intake to the hand dug ditch / lade JW38, which supplied water to the mill pond above Rysaurie farmstead. At NH 91753 25987. See photos PL31 and PL32

JW38 A hand dug ditch / lade 2 km in length runs from the western boundary of the survey area over the moorland down to the mill pond at Rysaurie. Some 100m above the mill pond is a spillway, marked today by

a single large boulder, where a similar ditch continues N along which the flow of water was diverted once the dam was full, in order to save someone making the 2Km trip up to the intake weir to divert the flow. The line of the spillway ditch was followed from near the hill fence above the farmstead beginning at NH 92299 25265, then heads roughly SW to the single boulder marking the spillway at NH 92306 25987, at which point the lade to the pond veers E, and the lade from the weir continues SW to NH 92245 25748 at which point also there appears to be a fork with a short length of ditch coming in from the S, possibly just a drain, to the weir JW37 on the un-named burn at NH 91753 25229. The un-named burn passes under the deer fence at NH 91745 25314. Back at the spillway marked by a boulder at NH 92306 25987, the lade swings NE to pass under the hill fence (post and Rylock) at NH 92331 25891.

JW43 Path from the Rysaurie hill gate at NH 92310 26120, to JW15 building at Badenargit (East).

JW51 A single sub-rectangular storage pit at NH 92516 25886, c3m x 2m x 0.75m deep. No photo.



Plate 9 Aerial view of Rysaurie
(Google Maps)

Discussion

A similar development to Auchtertipper seems likely at Rysaurie. 2 definite and one possible shieling huts were identified above the farmstead on the edge of rough grazing close to an un-named burn. Two of the huts have separate small dairies. They look out towards Badenargit about 500m to the north west.

There is much of archaeological interest at Rysaurie. Firstly there is the site of a probable horizontal mill, with its mill pond set up on a dry ridge, to be fed by a hand dug ditch 2 km in length, the weir being c10m from the western boundary of the survey area. Near to the mill pond there is a spill-way and a further 200m or thereby of hand dug ditch to divert water once the mill pond was full. The large timber built stable block has a date of 1903 on a door and is very well preserved. One later add-on of inferior construction has collapsed and a second is not far behind. This building – the older part that is, is worthy of conservation.

There are a number of older turf walled buildings at Rysaurie, one long house having been truncated by the main track to Rysaurie. Storage pits abound in groups at various locations around the farmstead.



Plate 10 Mill lade (Site LM22)

Conclusions

No prehistoric remains are visible anywhere in the survey area. Despite much of the survey area being covered in rank heather this statement is made with confidence. Every likely location was checked for the presence of hut circles and hundreds of in situ boulders in possible locations were checked for cup marks whilst passing. A number of smaller circular features are included in the survey but these are near the farmsteads, often close to other structures and are likely to belong to the historical period. This conclusion accords with that of Jonathan Wordsworth in 1996-7⁵. A considerable depth in time of structures was recorded, some almost certainly dating back to the medieval period. Although none of the farmsteads appear on General Roy's map c1750, early surveyors did not generally record unoccupied places. Following the turmoil of the years immediately after Culloden it is quite possible that the valley was either temporarily deserted or that occupation at that time was seasonal and Roy might have surveyed it outwith the season of occupation.

An interesting characteristic is the presence of 4 definite plus 1 probable lime kilns in the valley. Local information⁶ is that there is a source of limestone above Dulnain Bridge where there were a number of 'commercial' kilns. Most of the farmsteads and crofts at Skye of Curr, Dulnain Bridge, had their own lime kilns. Just two definite corn drying kilns were also noted, both at Auchtertipper, plus one possible at Lyndeor. Of note is the unusual mill feature at Rysaurie, likely to have been of horizontal type, with its mill pond set on a dry ridge fed by a hand dug ditch some 2 km in length. The timber range at Rysaurie is also of note being well preserved, with a date on one door, written in a fine hand in pencil, being 1903. The improved outfield shown on the 1st Ed OS is still clearly visible throughout the valley, being mostly the finer types of natural grasses, and was observed during the survey period to be much the favoured grazing by the hundreds of sheep in the valley.

⁵ Wordsworth, op.cit

⁶ George Grant, pers. comm.

Also of general note are the considerable number of old footpaths and tracks in the valley, some very well constructed, some shown on the 1st Ed OS, some not, nearly all fallen into disuse today, but they show how people got around between the shielings and farmsteads and indeed beyond in times past. They represent a variety of utilitarian uses also, including access to peat banks, gathering of livestock, access to shielings, and access to grouse butts.

What may be of particular note are 3 sections of track running generally north-south between the river and the B9007. Entries in both the National Monuments Record and the Highland Council's Historic Environment Record (HER) suggest that the military road lies entirely beneath the present line of the B9007. This may not be the case as has been previously thought. The 3 sections of track referred to above may be earlier military road. They are well constructed, taking direct lines over moraine ridges which have been cut through and the material used to make causeways over wetter ground. From the First Statistical Account, 1791 - 99, it is noted that Colonel Montgomery, Inspector General of military roads had recently surveyed the entire military road between Duthil and Dulsie Bridge and was proposing a new line for that road which would be 'at least 4 miles shorter'. It can be stated with confidence that all of the tracks depicted on the 1st Ed OS remain extant whether in use today or not.

History mentions Auchtertipper in relation to a maid and mistress of robes, 'Hilda Macdonnell of Auchtertipper', servant to Mariota de Athyn, concubine of the Wolf of Badenoch. Research into this medieval reference is ongoing at the time of writing, but it strongly suggests that Auchtertipper was occupied in the 14th c.

In very general terms archaeological evidence has been obtained to show that the probable historic settlement pattern here is likely to be similar to that demonstrated in Glen Feshie (Marshall 2005) and elsewhere, with first use being as summer sheiling grounds by one of the farms in the nearby Dulnain Valley, the two candidates being Dalbuiack and Balnastraid. As the population increased the best ground is likely to have been cultivated with a possible phase of summer farms which later became settled permanently.

Of particular note are the boundaries of the in-bye fields, most as depicted on the 1st Ed OS, but not all. They comprise ditches with walls alongside, the walls being made mostly by using the earth from the ditch plus some stones according to availability and no doubt turfs. Whilst these walls can be found on every farmstead, they are very fragmented and ruinous in places, particularly where field boundaries have been later realigned using post and wire fencing. No attempt has been made to record these for economic reasons due to their fragmentary nature. The best preserved ditch and field wall features are at Auchtertipper surrounding a large haugh field and several photographs have been taken. Where possible these ditches and walls have been overlaid onto the current OS 1:10,000 map.

The Second Statistical Account, 1834 -45, states that 'the turf built huts of former years are fast disappearing, and succeeded by stone and lime cottages, whose white-washed walls, and straw thatched roofs afford a pleasing contrast with their dingy predecessors.' This statement provides useful dating for some of the remains found. The present survey has produced plenty of evidence of turf walled buildings, drystone buildings and limed mortared stone buildings.

Recommendations

The surveyors were surprised to find such a wealth of surviving archaeological features albeit these appear to be of medieval or post-medieval date. We recommend that a 20-metre buffer zone be maintained around the sites recorded here. As there is considerable archaeological evidence present we also recommend that access routes to the sites involving vehicles and machinery be identified and checked by an archaeologist before the start of work on site.

References

Wordsworth J 1997 *Archaeological Survey of a Proposed Native Pinewood at Auchterteang, Cawdor Estate* (HHER EHG9; Report no. 10465)

Bing Maps. Accessed online at: <http://www.bing.com/maps>

RCAHMS (www.rcahms.gov.uk)

Highland Council Historic Environment Record (HHER) (<http://her.highland.gov.uk/>)

National Library of Scotland online map collection (<http://www.nls.uk/maps>).

The following maps were accessed at NLS online:

First Edition Six-inch to the Mile Ordnance Survey Map.

Blaeu, Joan. *Atlas of Scotland*, 1654

Roy, William. *Military Survey of Scotland*, 1747-1755

Where's the Path? Accessed online at <http://wtp2.appspot.com/wheresthepath.htm>

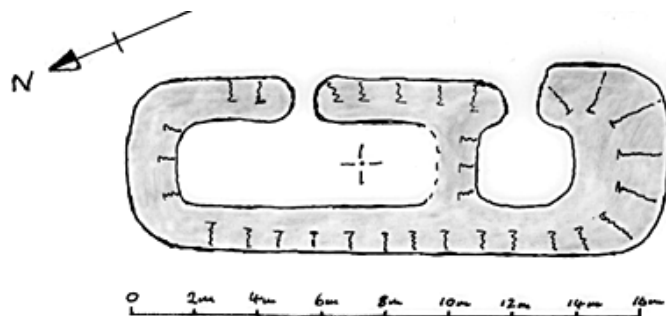

AUCHTERTIPPER FARMSTEAD

SITE LM2 CENTRED ON: 292976 828941

PROBABLE TURF WALLED LONG HOUSE

Date 11/10/2010 Drawn By JLO. at 1:200

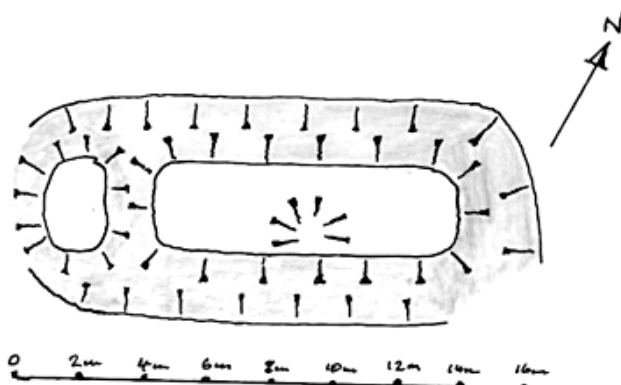

AUCHTERTIPPER FARMSTEAD

SITE JW6 CENTRED ON: 293084 828980

PROBABLE TURF WALLED LONG HOUSE

DATE 11/10/2010 Drawn by JLO. at 1:200.

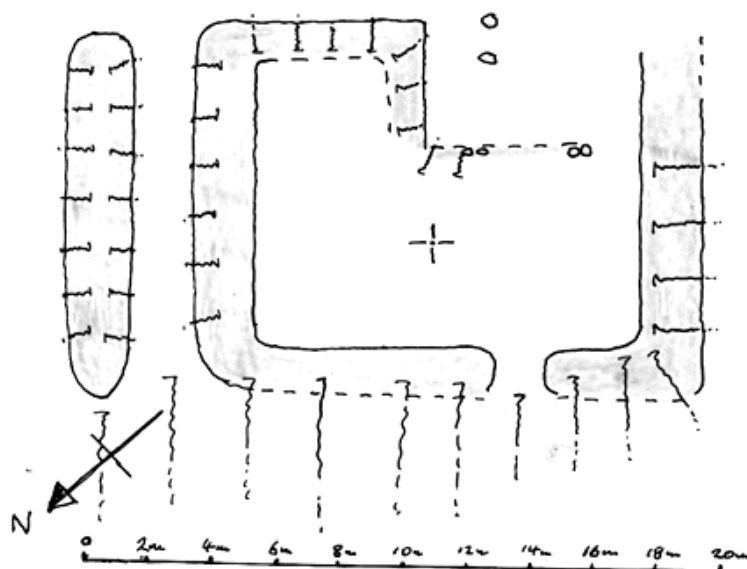

AUCHTERTIPPER FARMSTEAD

SITE JW5 CENTRED ON: 292990 823955

POSSIBLE PLATFORM AND STRUCTURES

Date: 11/10/2010 Drawn By: JLO. at 1:200

Figure 5 Auchtertipper sites LM2, JW5, JW6

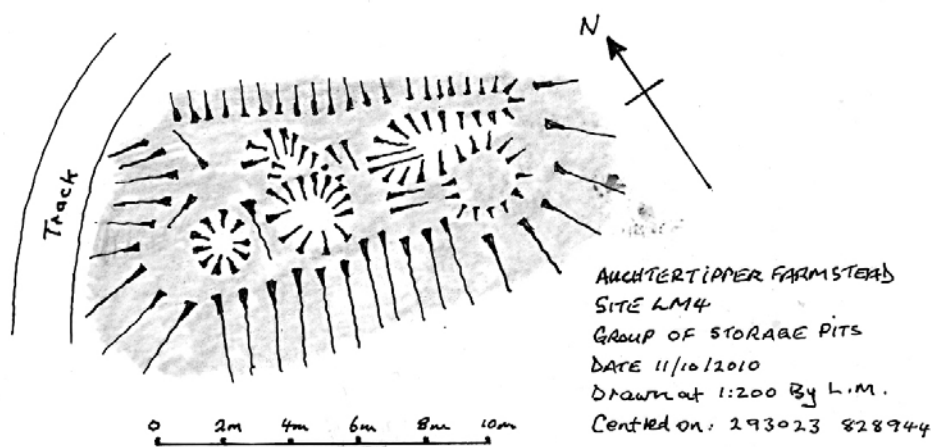
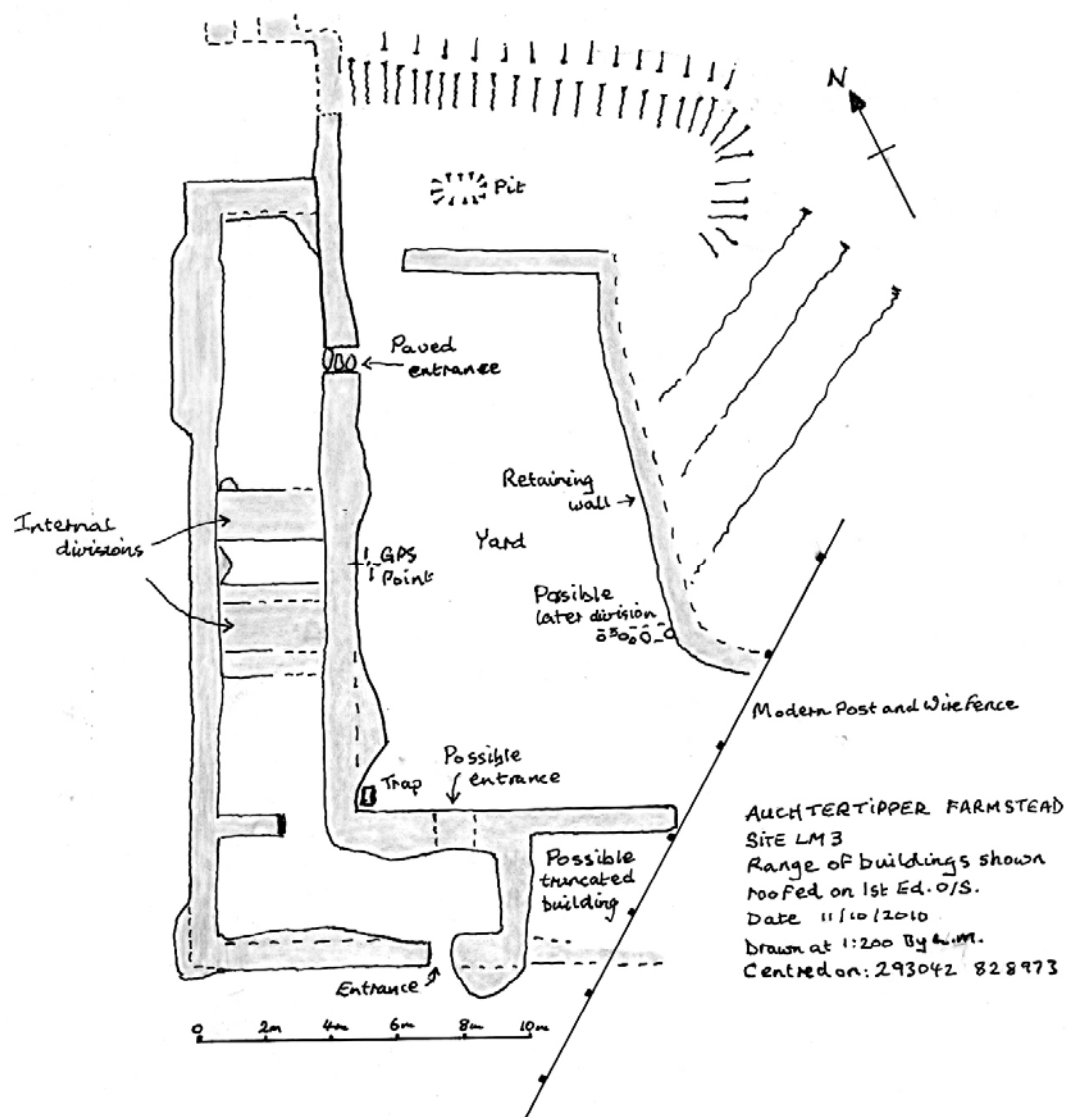
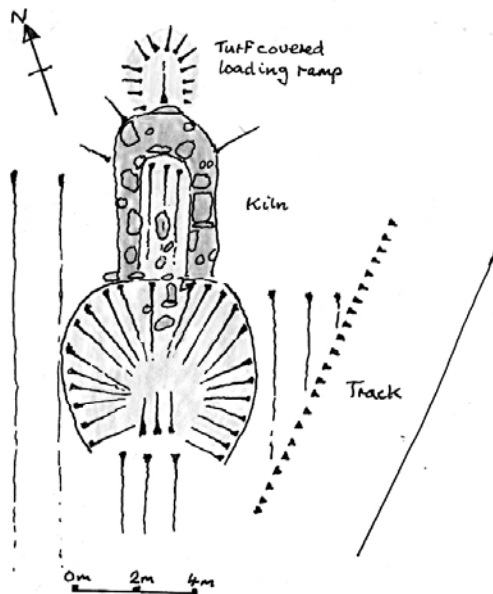
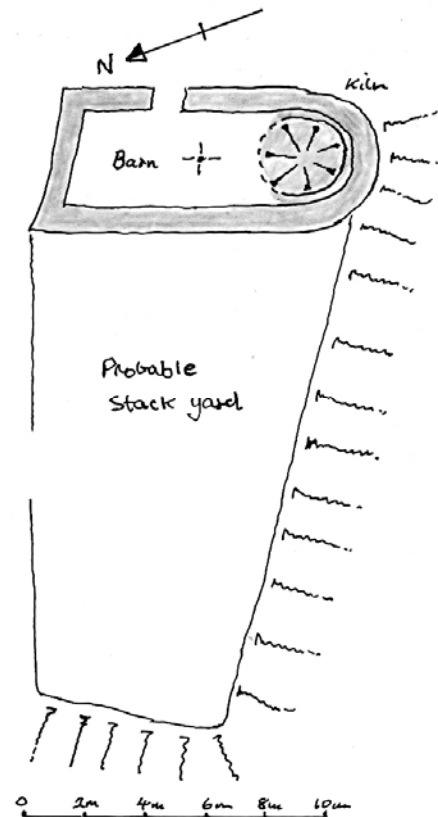

Figure 6 Auchtertipper sites LM3, LM4



AUCHTERTIPPER FARMSTEAD
SITE LM5
LIME KILN
DATE 11/10/2010
DRAWN AT 1:200 BY h.m.
CENTRED ON: 293352 828878



AUCHTERTIPPER FARMSTEAD
SITE JW7
CORN KILN, BARN & STACK YARD
DATE: 11/10/2010
DRAWN AT: 1:200 BY JLD
CENTRED ON: 293004 828935

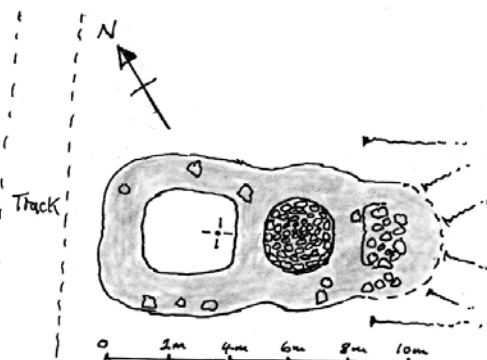

AUCHTERTIPPER - MOOR
SITE JW3 CENTRED ON: 292653 828567
CORN/MALT KILN & BARN
DATE 11/10/2010
DRAWN AT 1:200 BY JLD



AUCHTERTIPPER, CLOSE TO THE DUTHIL BURN
SITE LM1
SHIELING HUT WITH FLOOD DEFENCE
DATE 11/10/2010 DRAWN AT 1:200 BY JLD
CENTRED ON: 292955 829016

Figure 7 Auchtertipper Sites LM1, LM5, JW3, JW7

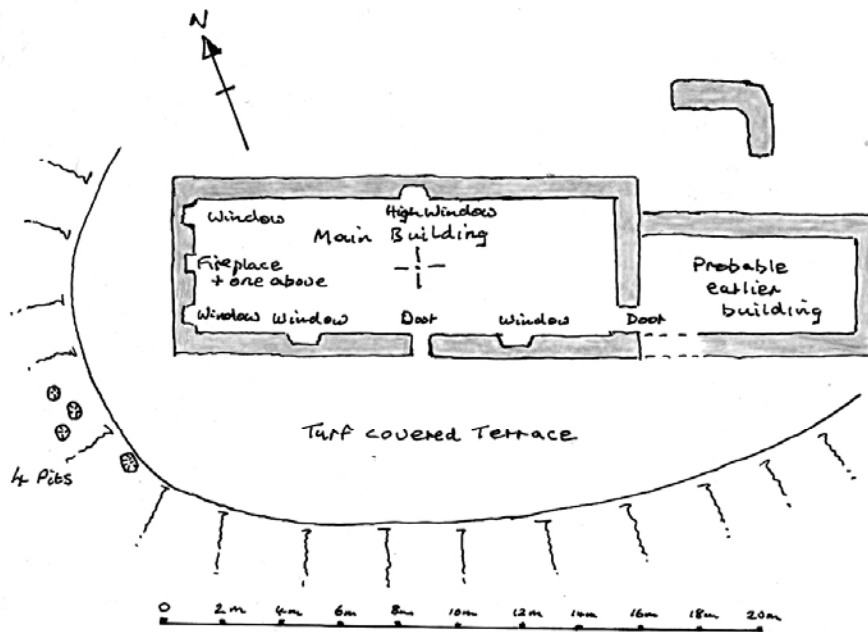

AUCHTERTIPPER FARMSTEAD

RUINED STONE and LIME FARMHOUSE

SITE: JW5 Centred on: 293074 28968

Date: 11/10/2010, drawn by: J.S. at 1:200.

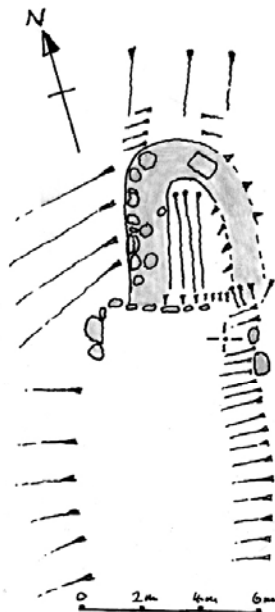

ESS FARMSTEAD

SITE LM7 Centred on:

LIME KILN 292883 827204

Date 14/10/2010, drawn by LM
at 1:200

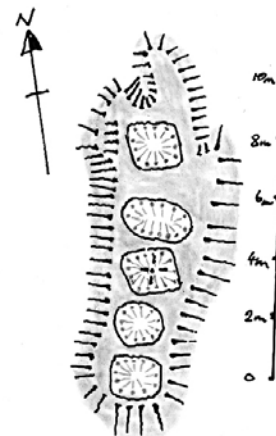

ESS FARMSTEAD

SITE LM10, Centred on: 292893 827250

GROUP OF STORAGE PITS

Date: 14/10/2010, drawn by L.A.
At 1:200

Figure 8 Auchtertipper site JW5; Ess sites LM7, LM10

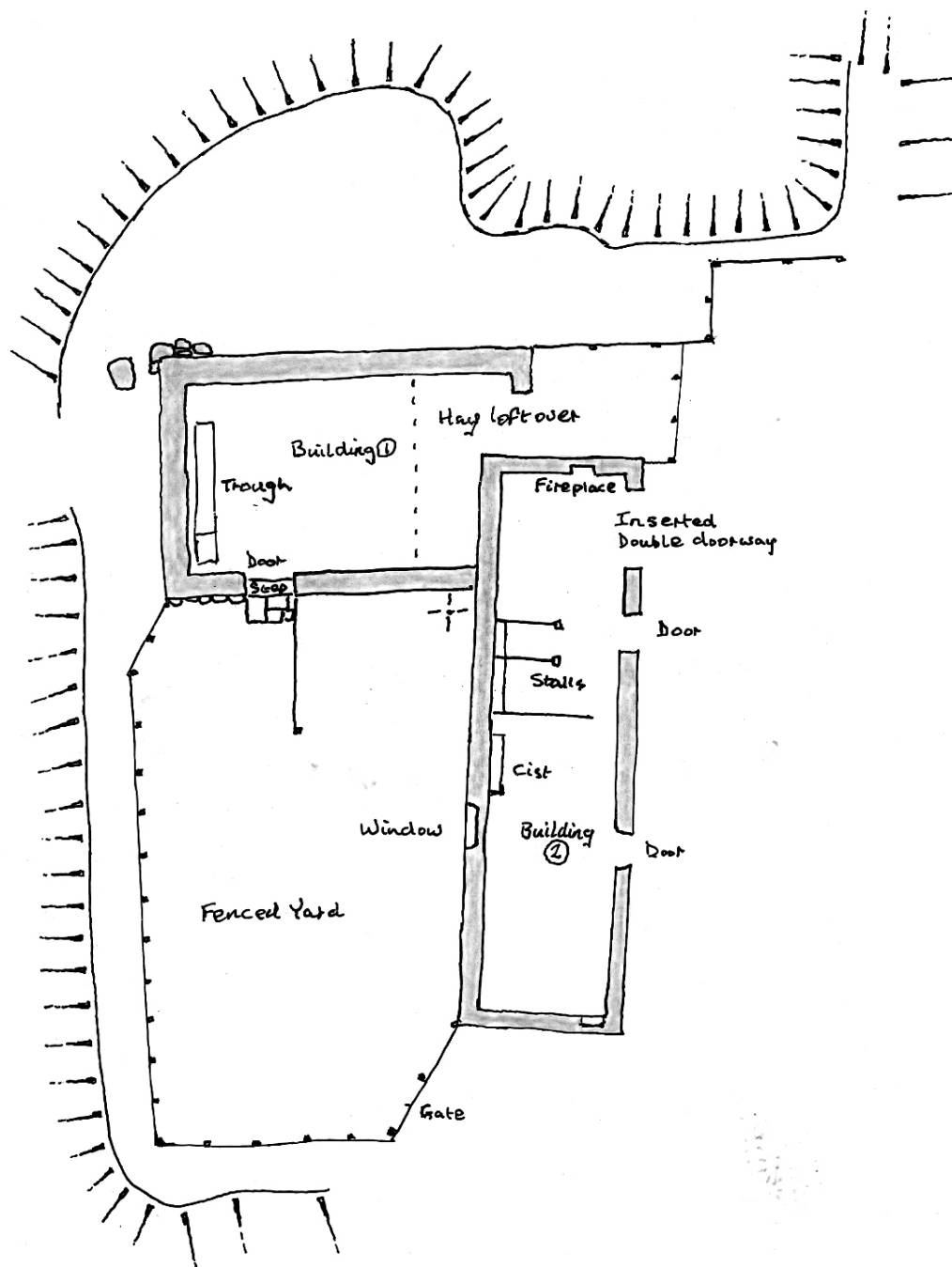

ESS FARMSTEAD

SITE: LM11 CENTRED ON: 292786 827186

FARM HOUSE, BYRE/CART SHED and BARN

Date 15/10/2010, Drawn by L.M. at 1:200

Figure 9 Ess site LM11

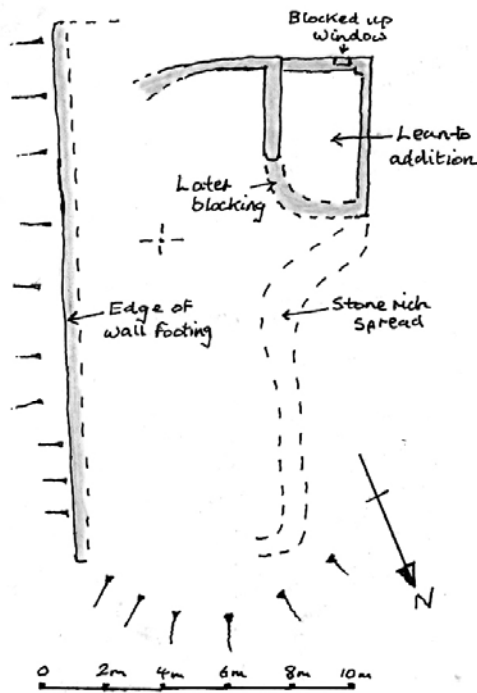

ESS FARMSTEAD
SITE LM12
RUINS OF SEVERAL BUILDINGS
CENTRED ON: 292 817 827242
DATE 15/10/2010 Drawn by: L.G.J.
At 1:200

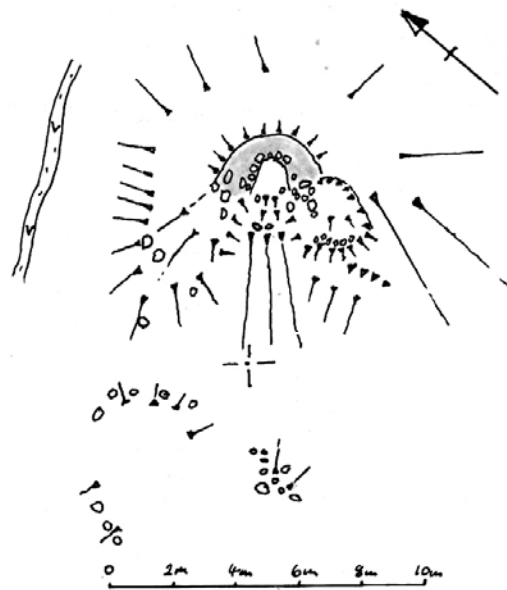

AUCHTERTEANG FARMSTEAD
SITE: LM 13
LIME KILN
CENTRED ON: 292 544 826507
DATE: 15/10/2010 Drawn by: L.G.J. At 1:200

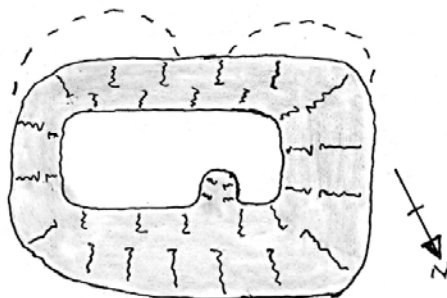

Auchterteang Farmstead
SITE JW 12
TURF WALLED BUILDING
CENTRED ON: 292410 826463
Date 15/10/2010 Drawn by: J.D. at 1:200

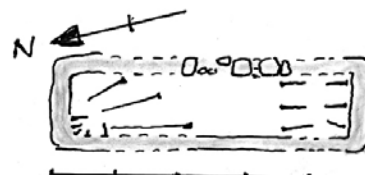

AUCHTERTEANG FARMSTEAD
SITE: LM 14 CENTRED ON: 292349 826465
BUILDING
DATE 15/10/2010 Drawn by: LM, at 1:200

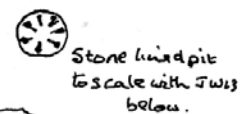

AUCHTERTEANG FARMSTEAD
SITE JW 13 TURF WALLED BUILDING
CENTRED ON: 292413 826455
Date 15/10/2010 Drawn by: J.D. at 1:200

Figure 10 Ess site LM12; Auchterteang sites LM13, JW12, JW13

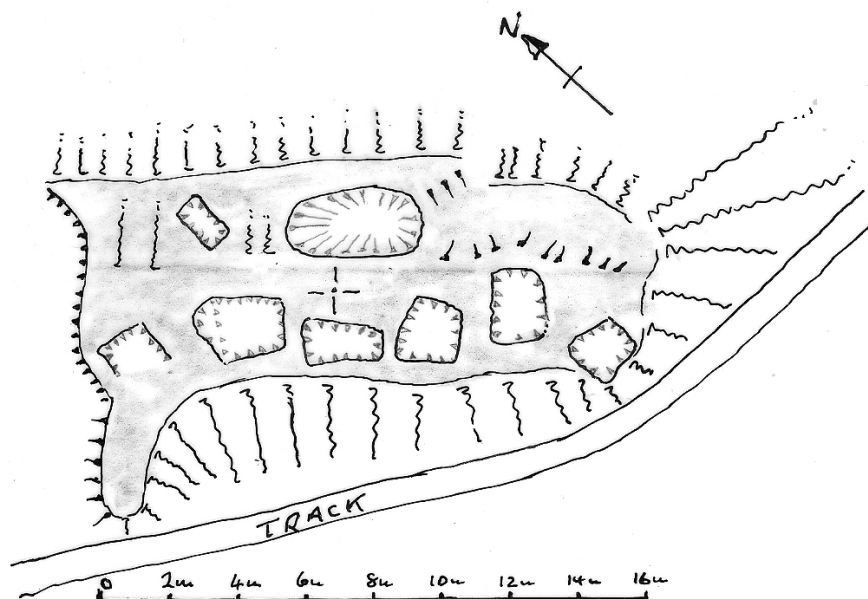

RYSAURIE FARMSTEAD

SITE NO LM26 CENTRED ON: 292 481 826 065

GROUP OF STORAGE PITS

DATE 18/10/2010 Drawn By L.M. at 1:200

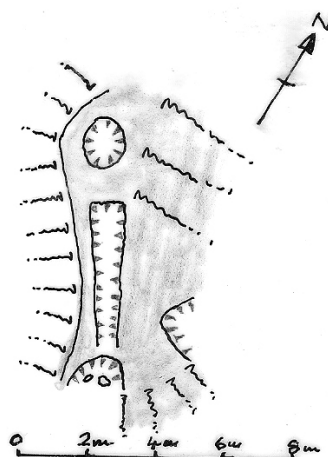

RYSAURIE FARMSTEAD

SITE NO LM24

CENTRED ON: 292 456 826 111

GROUP OF STORAGE PITS

DATE 18/10/2010 Drawn By L.M. at 1:200

Figure 11 Rysaurie sites LM24, LM26

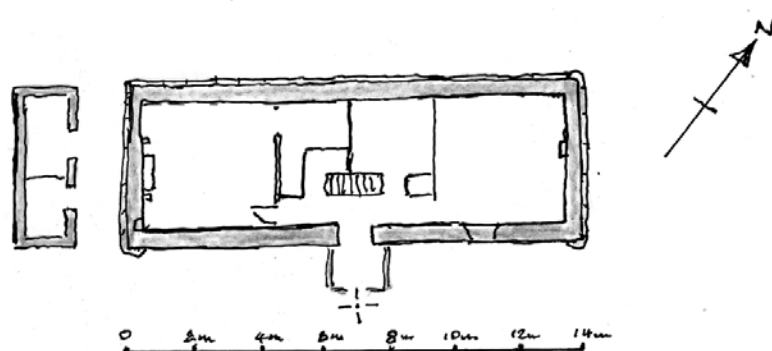

RYSAURIE FARMSTEAD

SITE NO: LM23 CENTRED ON: 292472 826091

MODERN/PART RUINOUS FARMHOUSE

Date 18/10/2010, Drawn By L.M. at 1:200

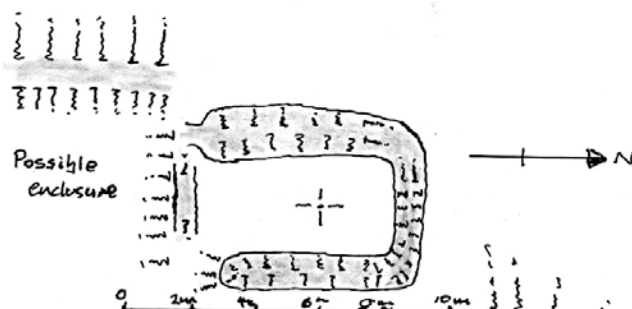

RYSAURIE FARMSTEAD

SITE NO LM28

CENTRED ON: 292252 826004

SHIELING

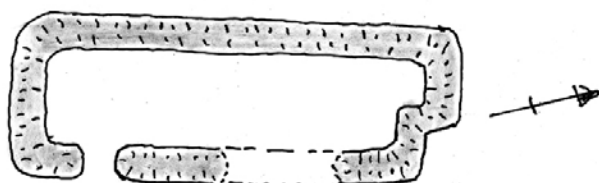
Date 19/10/2010 Drawn by L.M.
at 1:200

RYSAURIE FARMSTEAD

SITE JW9

CENTRED ON: 292217 825946

SHIELING HUT WITH DAIRY

Date 19/10/2010 Drawn By J.D.
At 1:200

Figure 12 Rysaurie sites LM23, LM28, JW9



Rysaurie Farmstead

Site LM16, Centred on: 292509 825991

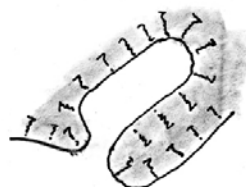
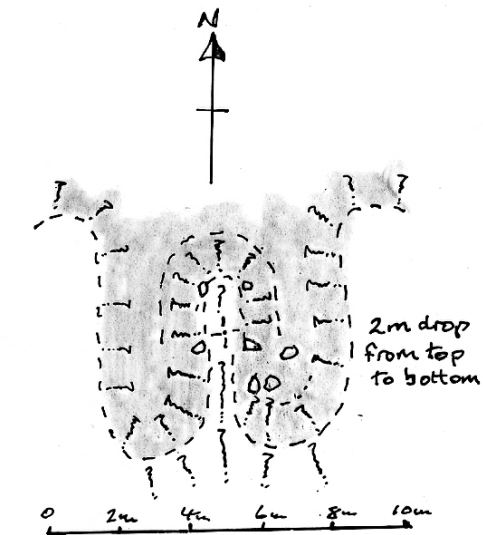
LIME KILN

Date 18/10/2010 Drawn by JLO at 1:200

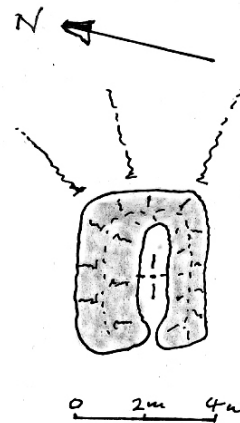

Rysaurie Farmstead

Site LM21

Centred on: 292525 826063

Turf Walled Building

Date 18/10/2010. Drawn by JLO at 1:200

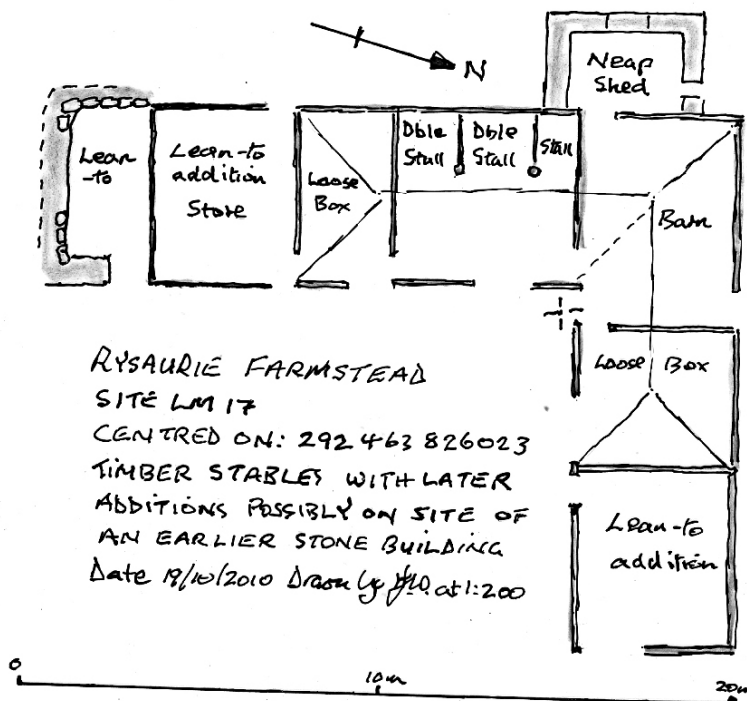

RYSAURIE FARMSTEAD

SITE LM17

CENTRED ON: 292463 826023

TIMBER STABLES WITH LATER ADDITIONS POSSIBLY ON SITE OF AN EARLIER STONE BUILDING

Date 18/10/2010 Drawn by JLO at 1:200

Figure 13 Rysaurie sites LM16, LM17, LM21

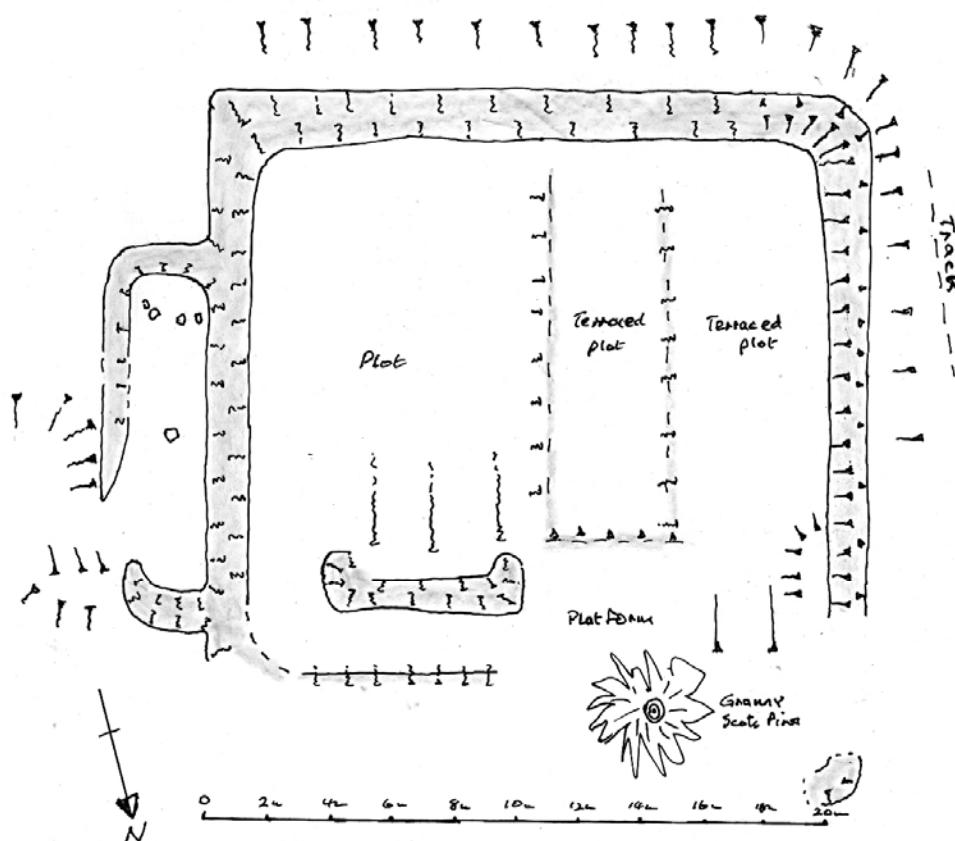

RYSAURIE FARMSTEAD

SITE: LM19 CENTRED ON: 292484 826045

KAIL YARD / KITCHEN GARDEN + BUILDINGS

Date 15/10/2010, DRAWN by L.G.T. and J.W. at 1:200

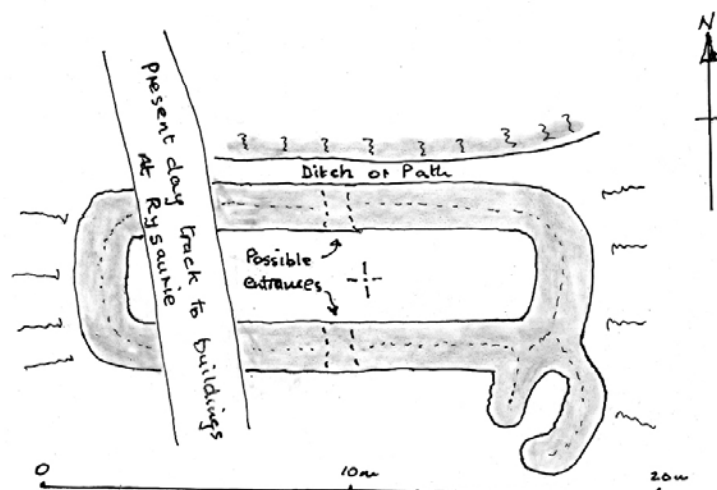

RYSAURIE FARMSTEAD

SITE: LM20 CENTRED ON: 292525 826043

TURF WALLED BUILDING WITH OUTSHOT

Date 15/10/2010 DRAWN by J.W. at 1:200

Figure 14 Rysaurie sites LM19, LM20

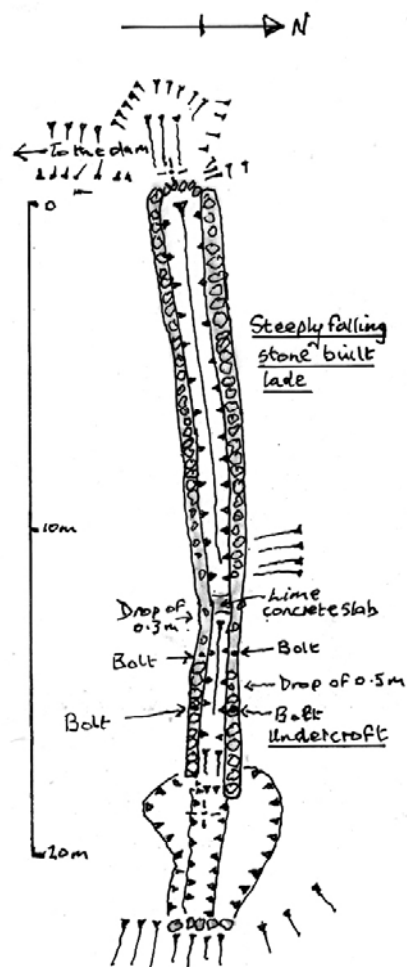

RYSAURIE FARMSTEAD

SITE LM18

MILL LADE and UNDERCROFT

NGRS - AT TOP: 292 391 826022

AT BOTTOM: 292 401 826032

Date 18/10/2010 Drawn by L.M. at 1:200

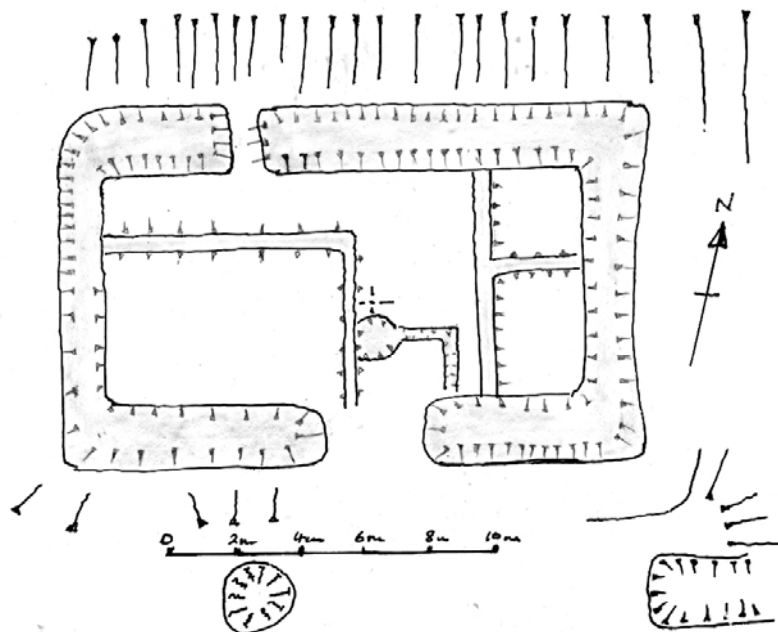

AUCHTERTEANG FARMSTEAD

SITE LM15 CENTRED ON: 292 318 826581

PROBABLE KAIL YARD WITH STORAGE PITS

DATE 15/10/2010 DRAWN BY L.M. at 1:200

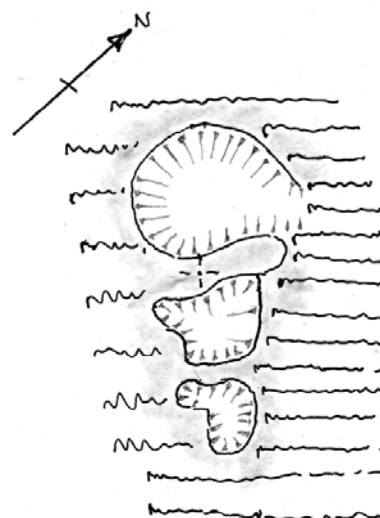

RYSAURIE FARMSTEAD

SITE LM27 CENTRED ON:

292 430 826051

3 STORAGE PITS

Date 18/10/2010 Drawn by L.M.

At 1:200

Figure 15 Auchterteang sites LM15, LM27; Rysaurie site LM18

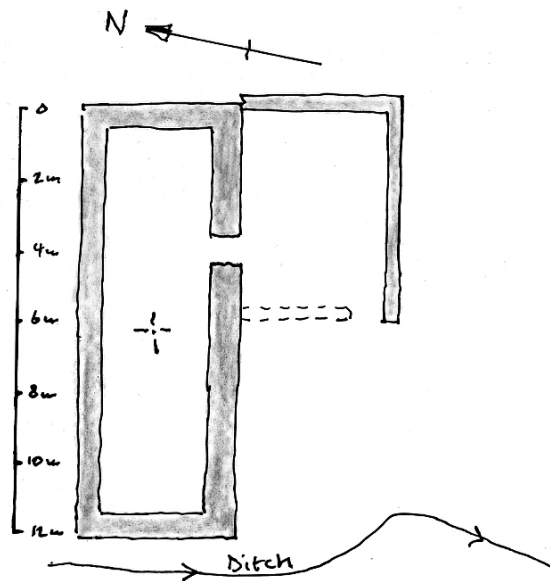

BADENARGIT FARMSTEAD (EAST)
 SITE: JW15 CENTRED ON: 292183 826260
 STONE FOOTINGS OF A BUILDING
 Date 18/10/2010 Drawn by J.F.O. at 1:200

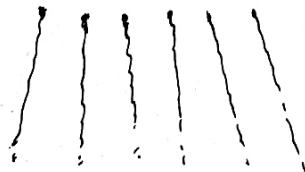
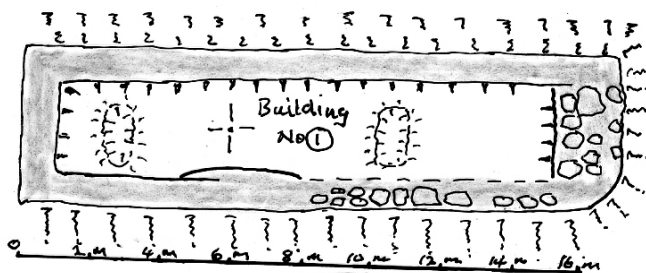

BADENARGIT FARMSTEAD (WEST)
 SITE LM31 CENTRES:
 No 1 291938 826324 No 2 291958 826334
 Date 18/10/2010 Drawn by L.M. at 1:200
 2, possibly 3 FOOTINGS IN STONE
 OF BUILDINGS SHOWN ROOFED
 ON 1st Ed OS.

Figure 16 Badenargit sites LM31, JW15

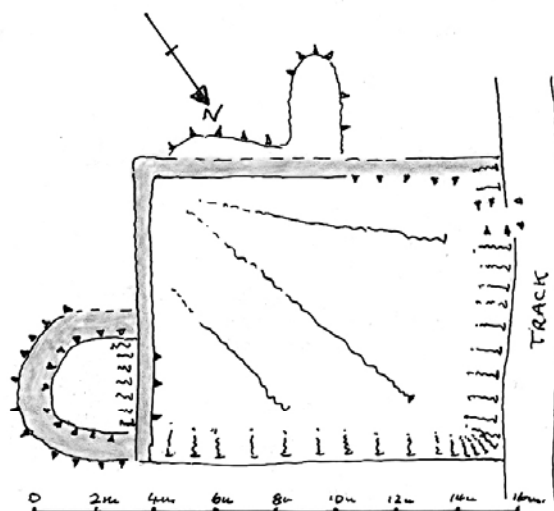

LYNDEOR FARMSTEAD

SITE JW 23, CENTRED ON: 292 340 825651

ENCLOSURE AND CIRCULAR STRUCTURE

Date 19/10/2010 Drawn by L.M. at 1:200

LYNDEOR FARMSTEAD

SITE JW 18

CENTRED ON: 292 350 825704

REMAINS OF BUILDING

Date 19/10/2010

Drawn By L.M. at 1:200

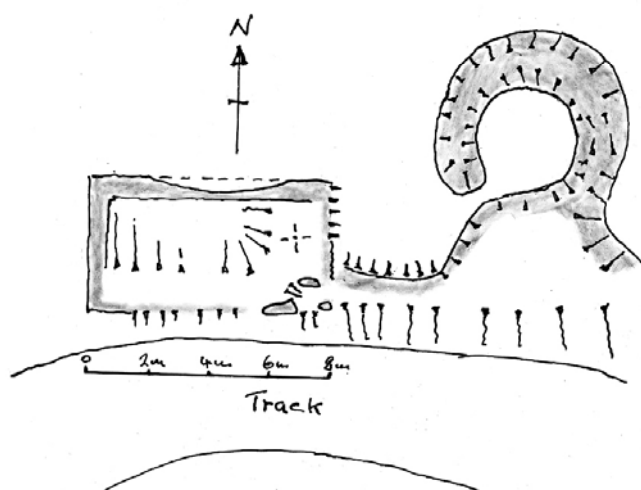
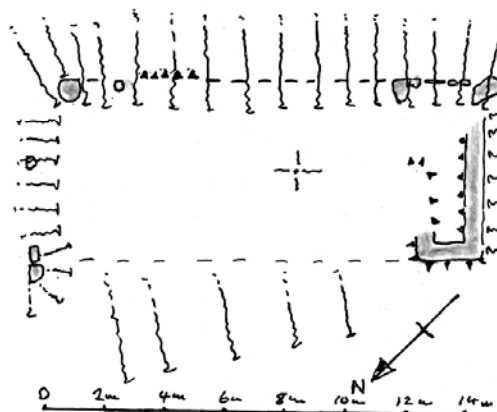

LYNDEOR FARMSTEAD

SITE JW 17

CENTRED ON:

2 BUILDINGS ON EDGE OF MOOR

Date 19/10/2010 Drawn By L.M. at 1:200

Figure 17 Lyndeor sites JW23, JW17, JW18

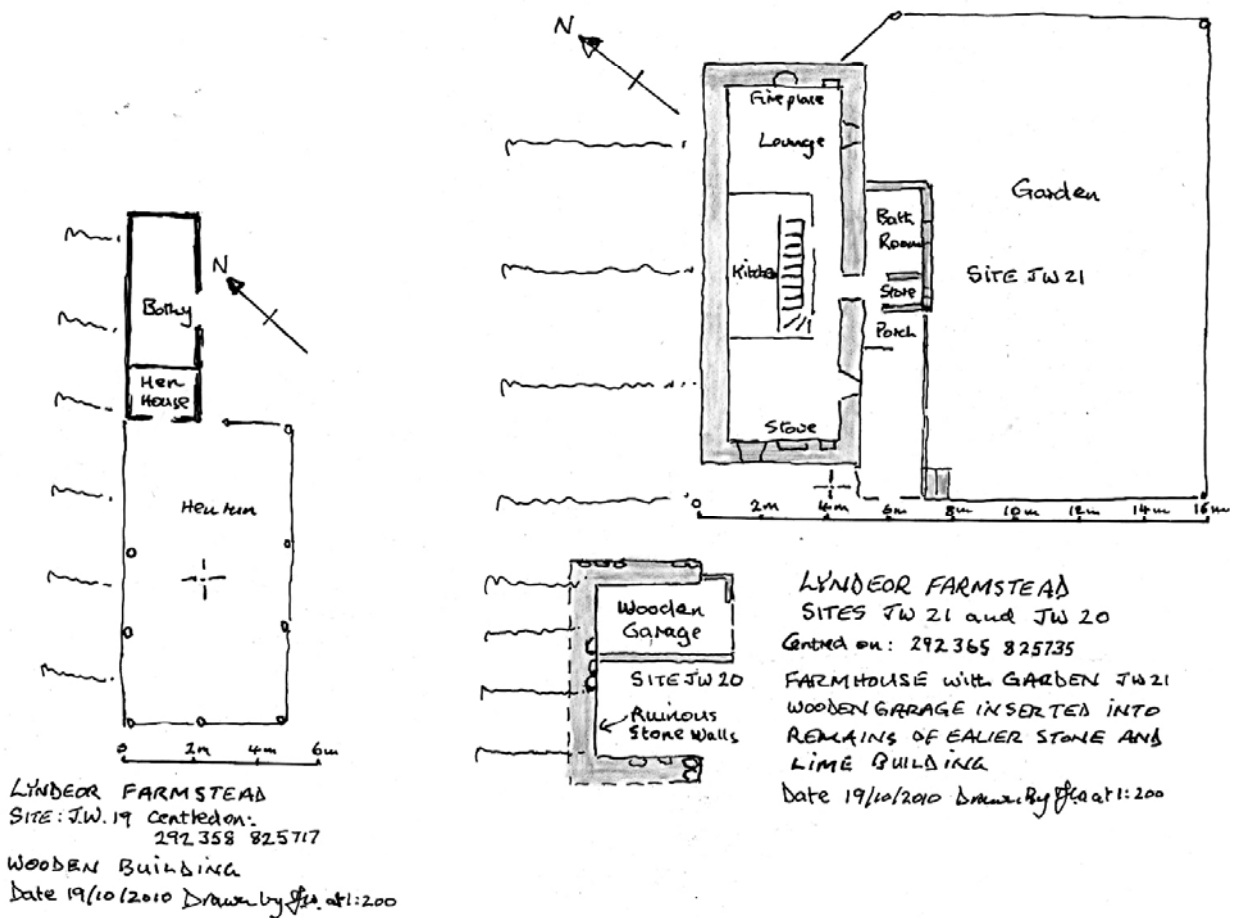
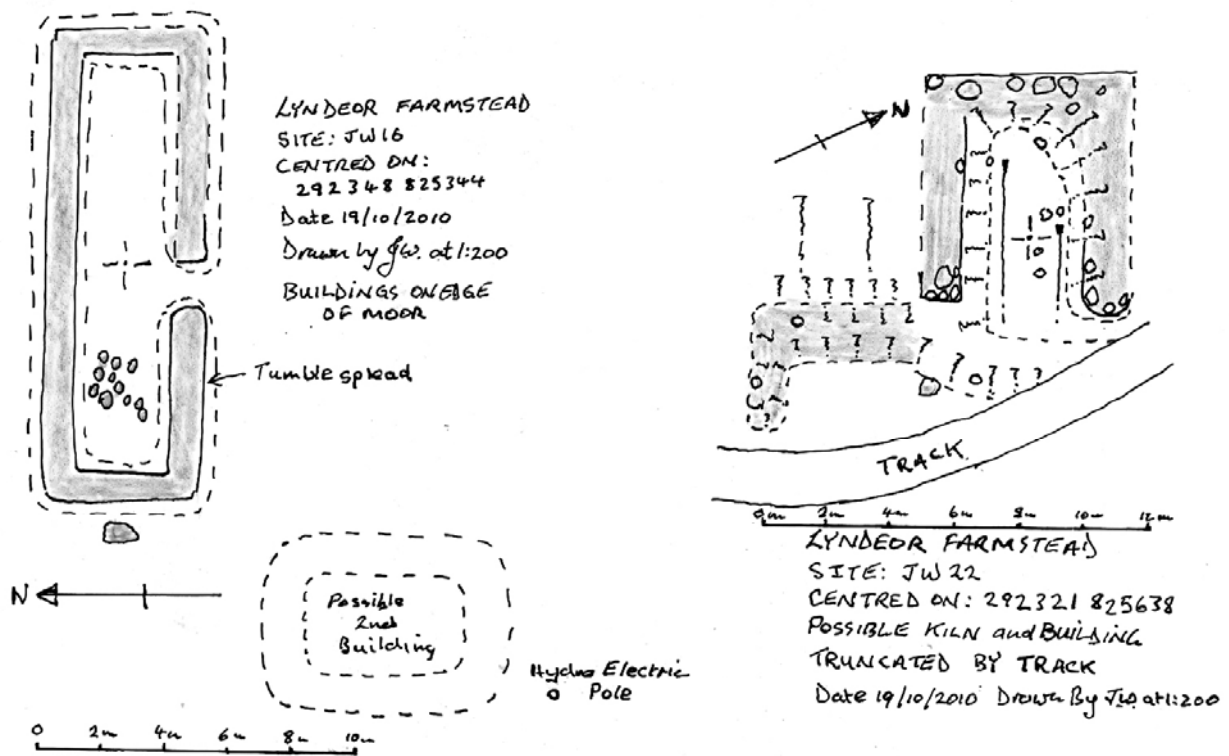

Figure 18 Lyndeor sites JW16, JW19, JW20, JW21, JW22,

APPENDIX 1: Index of Archaeological sites recorded during fieldwork

Site no.	Description	Sketch	Photo	Notes	NGR
JW1	Enclosure		PJ3	A small enclosure adjoining the large enclosed southern field in its SE corner, centred on: 292937 828076. sub rectangular, 10m SW/NE x 9m internal. S and E sides are heather covered earth banks, N and W sides are cuts into the natural moraine bank above. Also a small external platform on E side adjoins this enclosure, triangular in shape.	NH 9293 2807
JW2	Enclosure		PJ5-6	Enclosure shown on the 1 st Ed OS, inside the SW corner of the southern enclosed field, rectangular, centred on: 292868 828188, 17m NW/SE x 14m internal. Formed by heather covered earth banks. Photos PJ5 and PJ 6.	NH 9286 2818
JW3	Corn drying kiln and barn on the moor	Fig 8	PJ9-11	Corn drying kiln with barn attached, centred on 292653 828567, sits c 1Km SW of the nearest cultivated field. Well preserved kiln bowl has a diam of 2.5m at rim ht. Low stone footings protrude from a sea of rank heather. The site sits above a small lochan, and it is reached from the farmstead by a well constructed track which continues on past the kiln site for another 100m or so terminating at a natural hollow containing 4 small winter ponds. Approx 50m N of the kiln at 292627 826589 a strong spring arises, which then passes close to the kiln. The kiln, its barn and natural resources suggest that this was an illicit whisky production site: no still bothy could be found elsewhere on Auchtertipper ground.	NH 9265 2856
JW4	Group of storage pits		PJ15	Group of storage pits centred on: 293050 828940.	NH 9305 2894
JW5	Ruined farmhouse	Figs 6,9	PJ 18, PJ19, PJ21.	Roofless late 19C or early 20thC farmhouse, centred on 293074 828968, measures 14m E/W x 4.4m internal. Was one and a half storeys, lime mortar construction, dressed quoins, fireplaces ground and upper floors in W gable, E gable fallen.	NH 9307 2896
JW6	Turf walled building	Fig 6	PJ19,21	Turf walled longhouse centred on: 293080 829000, sub rect. c13m NE/SW x3m internal, wall spread to c2m, max ht 0.3m, rounded corners inside and out. Possible small compartment at SW end. No obvious entrance. See scale drawing and photo PJ 22.	NH 9308 2900
JW7	Corn kiln , barn and stack yard	Fig 8	PJ22	Corn drying kiln with barn attached and probable stack yard alongside, centred on: 293004 828935. Kiln bowl infilled, c2.5m diam at rim, kiln and barn together measure 9m NE/SW x 3m internal. Single central flue, blocked up with stones. Entrance in SE side wall. Walls double faced drystone, stones dressed to fit, stand to 1m max, o.75m wide. Most of wall tops and interior covered with fine turf. The attached stack yard is a raised platform, with entrance to N, but no enclosing walls or fence remain. No evidence of stack bases – whole area covered in fine turf. See scale drawing and photos PJ17 and PJ20.	NH 9300 2893

Site no.	Description	Sketch	Photo	Notes	NGR
JW8	Mound		PJ17,20	Possible dished mound, oval c4m N/S x 3m int, at 293150 828401.	NH 9315 2840
JW9	Shieling hut and dairy	Fig 13	PJ54	The scant heather covered footings of a substantial sub rect shieling hut, at 292217 825946, close to a small un-named burn, c12m N/S x 3m internal. Max wall spread of stones c1m. Entrance in SE corner. Part of E side wall missing. Small dairy c3.5m NW/SE x 1.5m with entrance to SE lies c6 N of the main structure and may an enhanced natural feature.	NH 9221 2594
JW10	Enclosure		PJ55	A small enclosure or pen at 291905 825970, 10m N/S x 8m internally, walls boulders and turf, spread to 3m wide, standing to 0.5m max. Abuts the ditch and bank which encloses a large regular shaped field of the better ground at Badenargit.	NH 9190 2597
JW11	Enclosure		PL25	A substantial enclosure at Badenargit West, at 291900 826325, c20m square, shown on the 1 st Ed OS, beside the buildings. Substantial walls of boulders, stones and turf. See photo PL25.	NH 9190 2632
JW12	Turf walled building	Fig 11	PJ50	The low turf covered footings of a probable turf walled building at 292410 826463, truncated by a modern fence, measures c7m E/w x 3m internal, wall spreads up to 3m, c0.4m high, no obvious entrance.	NH 9241 2646
JW13	Turf walled building	Fig 11	PJ51	A similar smaller building near to JW12, at 292413 826455, measures c3m E/W x 2m internally, clear entrance on S side, stone lined pit c1.5m diam close by.	NH 9241 2645
JW14	Road		PL45-6	Section of old well built road, survives to c2.3m wide in places, leaves the line of public road above Ess Falls, at 293066 827735 heading N to reach the SE corner of the large walled field at Auchtertipper, at 293017 828054. At 293027 828045 it crosses the Allt a Ghuail.	NH 9306 2773
JW15	Stone footings		PJ57	Badenargit East, the stone footings of a very wasted 'L' shaped building shown roofed on the 1 st Ed OS, at 292183 826260. Single course only remains of the double faced walls, built of large stones. See scale drawing and photo PJ57. A footpath runs direct from this structure over dry ground towards the Rysaurie hill gate.	NH 9218 2626
JW16	Stone footings	Fig 19	PJ56	The stone footings of a building at 292348 825394, measure 13m E/W x 3m internally. Double faced walls now spread to c2m. Entrance in S side. Wasted and indistinct around E gable end. Another possible building exists as low footings c5m N/S x 3m internally 4m SW of JW16, close to the hydro electric pole.	NH 9234 2539
JW17	Building	Fig 18	PL34	A sub-rectangular building at 292292 825711, badly truncated by the bulldozed track alongside, would have measured c7m E/W x 3m internally. Some stone work still remains, turf and rush covered. To the immediate NE lies a circular feature c 3.5m int diam, walls spread to c2m.	NH 9229 2571
JW18	Building	Fig 18	PL36	A roofed building is shown on the 1 st Ed OS at this stance at 292350 825704, now swept away. Just enough of the footngs remain to suggest a lime mortar building c13m NE/SW x 3.5m internally.	NH 9235 2570
JW19	Timber bothy, hen house and	Fig 19	PL37	A wooden bothy with hen house and hen run attached, at 292358 825717.	NH 9235 2571

Site no.	Description	Sketch	Photo	Notes	NGR
	hen run				
JW20	Timber garage inserted into 19thC ruin	Fig 19	PL38	Modern timber garage set into the remains of an earlier stone and lime building, at 292345 825720, which was cut into the natural bank behind.	NH 9234 2572
JW21	20thC farmhouse	Fig 19	PL39	Early 20 th house, lime mortar and stone construction with later bathroom and store added to the front, at 292360 825725.	NH 9236 2572
JW22	Structure	Fig 19	PL35	Stone walled structure cut into steep bank at 292321 825638. Much slumping of stones and earth within. A second feature attached has been truncated by a track.	NH 9232 2563
JW23	Enclosure	Fig 18	PL34	An enclosure about 10m square, with semi circular feature attached at 292340 825651. S and E walls turf and stone N and W walls revetted into the natural slopes.	NH 9234 2565
JW24	Group of storage pits and an oval stance			JW24 A group of storage pits and an oval stance at approx. 292463 825833. See photo PL40.	NH 9246 2583
JW25	Group of storage pits			JW25 A group of storage pits at approx. 292513 825886. See photo PL41.	NH 9251 2588
JW26	Storage pit			A single square shaped storage pit at NH 92533 25866, c2m x 2m. No photo.	NH 9253 2586
JW27	Pits			Two circular pits clearly man made, E of the river near the track which forms the boundary of the survey area, at 292663 825072, cut into a moraine mound, today filled with water. No photo.	NH 9266 2507
JW28	Possible graves beside old track		PJ58	Two possible graves at 292704 825343, on E side of river dug in the top of a dry mound, also near to the boundary track. One measures 1.8m E/W x .06m and the other 1.2m E/W x 0.6m.	NH 9270 2534
JW29	Wooden dam above Ess falls			A dam above Ess falls at 292950 827811, c7m long, with a drop of c1m on the downside, constructed of round poles c200mm diam, bolted vertically to each other and horizontally to vertical 75mm x 75 mm square posts. The purpose of the dam appears to have been recreational, either for swimming or fishing. Today the pool above is completely filled with gravel.	NH 9295 2781
JW30	Sample unlined grouse butt disused		PL44	Sample of an unlined grouse butt in the line extending above Ess falls across the B9007.	NH 9299 2777
JW31a	Pit			2 stone filled pits, (a): c3m x 2m at 293197 828450. No photo.	NH 9319 2845
JW31b	Pit			2 stone filled pits, (b) c2m x 1.5m at 293212 828450. No photo.	NH 9321 2845
JW32	Grouse butt		PL48	Sample grouse butt at 291806 827296, in a line running N/S on the W boundary of the	NH 9180 2729

Site no.	Description	Sketch	Photo	Notes	NGR
				survey area. Half circle in shape, 2.5m wide, walls 1.5m wide, 1.4m deep, stone faced. See photo LM 48	
JW33	Grouse butt			Sample grouse butt at 291701 828311. Key hole in plan, mostly turf construction, low down internal stone facing.	NH 9170 2831
JW34	Footbridge (derelict)		PL55	Sample of a derelict footbridge constructed using 2 lengths of narrow gauge rails, at 292572 828110.	NH 9257 2811
JW35	Ponds			Group of 4 winter ponds at end of track, 292635 828530, which serves the corn / malt drying kiln on the moor. No photo.	NH 9263 2853
JW36	Ponds		PL47	The kettle hole ponds below farmhouse, as depicted on the 1 st Ed OS, enhanced by linked ditches, with a shallow subrectangular pond at the lower end being purpose dug, possibly for flax retting. Centred on 293090 828930.	NH 9311 2896
JW37	Weir		PL31-2	A small weir constructed of boulders, 2 courses visible, with a water level drop of c 0.5m, formed the intake to the hand dug ditch / lade JW38, which supplied water to the mill pond above Rysaurie farmstead. At 291753 825987.	NH 9175 2598
JW38	Ditch		PL32	A hand dug ditch / lade 2 km in length runs from the western boundary of the survey area over the moorland down to the mill pond at Rysaurie. Some 100m above the mill pond is a spillway, marked today by a single large boulder, where a similar ditch continues N along which the flow of water was diverted once the dam was full, in order to save someone making the 2Km trip up to the intake weir to divert the flow. The line of the spillway ditch was followed from near the hill fence above the farmstead beginning at NGR 292299 825265, then heads roughly SW to the single boulder marking the spillway at 292306 825987, at which point the lade to the pond veers E, and the lade from the weir continues SW to 292245 825748 at which point also there appears to be a fork with a short length of ditch coming in from the S, possibly just a drain, to the weir JW37 on the un-named burn at 291753 825229. The un-named burn passes under the deer fence at 291745 825314. Back at the spillway marked by a boulder at 292306 825987, the lade swings NE to pass under the hill fence (post and Rylock) at 292331 825891.	NH 9192 2542
JW39	Path			A well constructed disused probable shooters path leaves the public road above Ess falls and heads off over the rough moorland more or less in a straight line, crossing the Duthil Burn by a derelict footbridge identical to JW34, to become indistinct above the second footbridge JW34 not far from a line of grouse butts. From JW34 above, it runs SE to a footbridge over the Duthil Burn at 292932 827921, then to 293006 827879 from where there is a choice of either heading straight up to the B9007 or following the river side path S to Ess farmstead.	NH 9259 2810
JW40	Hut		PL49-50	Garrocher Lunching Hut	NH 9132 2826
JW41	Road			A section of well built old road linking Lochgorm to Lyndeor and Rysaurie is shown clearly on the 1st Ed OS and that part within the survey area remains extant.	NH 9236 2561
JW43	Path			Path from the Rysaurie hill gate at 292310 826120, to JW15 building at Badenargit	NH 9231 2612

Site no.	Description	Sketch	Photo	Notes	NGR
				(East).	
JW44	Path			The well formed path which links Badenargit West from 291950 826310 and Badenargit East at 292192 826260, shown clearly on the 1 st Ed OS remains extant.	NH 9195 2631
JW45	Track			The track from the west side of the cultivated ground leading out to the corn / malt drying kiln on the moor, runs from approx 292980 828680, to the winter ponds at 292635 828530, in more or less a straight line.	NH 9298 2868
JW46	Track		PJ34	Revetted track running c100m from LM9 enclosure to the lime kiln LM7.	NH 9262 2737
JW47	Enclosure			A double enclosure shown on the 1st Ed OS on a narrow terrace above the E bank of Duthill Burn, now covered with mature birch trees. A narrow path comes and goes between the small enclosure LM9 and this double enclosure, then continues a short distance with remains of a turf wall on the lower side a short distance down to the river at approx 292923 827468.	NH 9292 2733
JW48	Stone walled enclosure		PJ53	Substantial stone walled enclosure shown on the 1 st Ed OS, measures c30m NE/SW x 20m internally with an entrance to the NE, at 292402 826505.	NH 9240 2650
JW49	Hut		PJ52	Nissen hut on earlier stance	NH 9242 2650
JW50	Road			Section of old road marked on the 1st Ed OS running NE from 293260 829040 at Auchtertipper farmstead to the public road, B9007, at 293547 829388. Covered in rank heather, disused for a long time, but originally well constructed. C 2m av width.	NH 9326 2904
JW51	Pit			A single sub-rectangular storage pit at 292516 825886, c3m x 2m x 0.75m deep. No photo.	NH 9251 2588
LM1	Shieling hut near burn below farmstead	Fig 8	PJ12-13	Sub rectangular shieling hut, on a small haugh, regularly flooded, close to the burn at 292955 829016, 8m NW/SE x 2.75m internal, round corners inside and out, entrance in SE corner. Walls spread to c1.5m, standing 0.3m high max. All heather covered, just a few wall stones showing. The north gable has been protected from flooding by a 'V' shaped piece of walling, of which only the double faced cobble footings remain, c 0.75m wide.	NH 9295 2901
LM2	Long house, heather covered	Fig 6	PJ14	The heather covered footings of a sub rectangular building, probably a turf walled long-house, at 292975 828941, 14m NW/SE x 2.5m internal. A small compartment shows to the SW. Wall spread to 2m, but to 3m with considerable battered underbuilding at SW. Wall ht to c0.3m, corners round inside and out. 2 entrances in SE side wall.	NH 9297 2894
LM3	Farmhouse + range	Fig 7	PJ18	A complex 'L' shaped range of utility farm buildings, at 293040 828980 plus a yard, depicted roofed on the 1st Ed OS, plus an attached yard. Walls much tumbled, all of drystone construction, double faced, standing to c 1.5m high max. Several divisions can be seen and signs of alteration over time. The longest leg of the complex measures 22m NE/SW x 3m internal. A modern fence truncates the leg extending SW.	NH 9304 2898
LM4	Platform, ditch and possible	Fig 7	PJ16	A group of storage pits, at 293023 828944.	NH 9302 2894

Site no.	Description	Sketch	Photo	Notes	NGR
	rect footings				
LM5	Lime kiln	Fig 8	PJ23-4	The horseshoe shaped remains of a once substantial lime kiln, at 293352 828878, cut into SE face of a moraine mound. Dry stone walls c1.2m thick show 3 courses at the back of the kiln, but all of the front wall including the lintels, has been robbed out. The drop from the top of the kiln to the rake out floor is c2m. Turf covered loading ramp c2m long still visible above the back rim of the kiln.	NH 9335 2887
LM6				Sample grouse butt, at 291900 830043, No 9 in that line, just above the NW limit of the survey area. Key hole in plan, c1.5m diam with an entrance passage c2.5m long, and .45m wide. The wooden peg with a '9' carved into it survives alongside.	NH 9190 3004
LM7	Lime kiln	Fig 9	PJ36	The wasted remains of a lime kiln at 292883 827204. Horseshoe shaped, much robbed. Internal length of the horse shoe c4m. Large work area below. Faces SW.	NH 9288 2720
LM8	Possible second kiln beside LM7		PJ37	A possible lime kiln represented as a cut bowl with work area below, at: 292886 827193, close to the more definite kiln LM7.	NH 9288 2719
LM9	Enclosure			A small enclosure on a sloping bank at 292922 827248, 25m x 11m internally, which truncates the good revetted path from the lime kiln. On 3 sides the enclosure is formed by substantial ditch and banks, on the 4th N side how the enclosure was closed is unclear. Photo PJ34 shows the enclosure in the distance whilst PJ35 was taken from within it of the group of nearby pits LM10. The track between this enclosure and the lime kiln may have continued to link with the path to the double enclosure JW7 at one time.	NH 9292 2724
LM10	Storage pits	Fig 9	PJ35	A group of 6 storage pits on a dry bank at 292894 827252.	NH 9289 2725
LM11	Building	Fig 10	PJ38-47	A substantial stone and lime building with barn attached at 292786 827186, to form an 'L' shape in plan, with fenced yard to rear. The building has undergone various alterations and changes over time. Walls c550mm wide, wall head 1.8m. It has some interesting internal features and numerous period artefacts remain in the building some of which were photographed. See scale drawing and photos PJ38, PJ39, PJ40, PJ47, PJ44, PJ45, PJ46, PJ41, PJ42 and PJ43.	NH 9278 2718
LM12	Ruined stone and lime building		PJ48	The poor remains of one or more stone and lime buildings, at 292817 827242, on a substantial stance. The only part retained has been patched to create a temporary pen. The remainder appears to have been bulldozed.	NH 9281 2724
LM13	Lime kiln	Fig 11	PJ49	A ruined lime kiln at 292544 826507, much robbed and eroded by livestock, cut into the S side of a moraine bank, has a large work area below and the possible remains of an oval stance a few m away to the W.	NH 9254 2650
LM14	Longhouse footings		PL1	At 292349 826465 are the stone footings of a building on a terrace above the main building on the S side of the Garrocher Burn, c9m N/S x 2m internally. Wall footings c0.7m wide stand to 0.5m max in ht.	NH 9234 2646

Site no.	Description	Sketch	Photo	Notes	NGR
LM15	Enclosure	Fig 16	PL2-3	A substantial but ruined enclosure c17m E/W x 12m internally, at 292318 826581, walls of stone and turf, spread to c2m, stand to 1.3m on the N side, entrance on the S side. Several compartments within the enclosure, interpretation unclear. May have been an enclosure with wooden huts inside, may also have been a kail yard at some time as there are 2 large storage pits just outwith the enclosure on the S side.	NH 9231 2658
LM16	Lime kiln	Fig 14	PL4	A very ruinous lime kiln at 292509 825991, set into a S facing bank. Very little left other than a horse shoe shaped depression. 2m vertical drop from loading point to working floor, which has been truncated over time due to ploughing of the adjacent field.	NH 9250 2599
LM17	Timber range	Fig 14	PL13-7 PL28-9	A substantial high quality timber built range, 'L' shaped in plan with stalls for 5 horses, 2 loose boxes and a barn with neap store attached, at 292463 826023. A date inscribed on one internal door is 1903. Two later lean-to poor quality timber additions added, one now dilapidated and the second also poor. The building sits on a dwarf wall c300mm wide and 300mm deep of lime mortared stones. The frame of the main and older building almost entirely of 150mm x 62mm Scots pine, apart from the main corner posts which are 150mm square. Vertical studs at 800mm centres. Dwangs 95mm x 35mm at 750mm vertically. Roof clad with corrugated iron, hip ends, galv iron gutters, 5 CI skylights. Outer cladding - vertical boards with weather overlap.	NH 9246 2602
LM18	Mill lade	Fig 16	PL15-16	A lime mortared stone sided lade with the undercroft of a possible late horizontal mill at its lower end. NGRs: end of undercroft at 299401 826032, beginning of undercroft 292398 826030, top of the stone lade 292391 826022. The last remains of what is likely to have been the bottom rail of a timber mill house lie adjacent to one of 4 x18mm diam bolts set into the top of the stone undercroft. The undercroft is filled with stones, earth and scrap iron – a bicycle frame, buckets and oil drums etc. At the top of the stone work the lade turns 90 degrees to the S and from there to the mill pond (LM22) the substantial lade is unlined. From the top of the stonework the unlined lade passes through 292403 825577, 292401 825960, 292388 825594, 292383 825939 where the remains of a 150mm diam post marks the possible position of a sluice gate. It ends well into the pond at 292374 825929. See scale drawing and photos PL 15, PL16, PL18 and PL19.	NH 9239 2603
LM19	Kail yard / later kitchen garden	Fig 15	PL5-6	A ruinous walled enclosure, shown on the 1st Ed OS, centred on 292484 826045, with possibly 2 buildings attached likely to have turf walled. The enclosure measures 19m E / W x 14m internally. The larger attached building measures 10m N/S x 3m internally, with a possible entrance in the NE. Interpreted as originally a kail yard, later a kitchen garden worked in 3 terraced plots.	NH 9248 2604
LM20	Turf walled building truncated by track	Fig 15	PL7	The turf covered footings of a likely turf walled building centred on 292525 826043, truncated by the present vehicle track to the farmhouse. Wall spreads to c1.5m, ht c0.3m. Hook shaped outshot in the SE corner. See scale drawing and photo PL7. Probable ditch to N side.	NH 9252 2604
LM21	Small turf	Fig 14	PL8	Small turf walled building at 292525 826063, c3m E/W x 1m internal.	NH 9252 2606

Site no.	Description	Sketch	Photo	Notes	NGR
	walled building				
LM22	Mill pond dam and lade		PL18-19	Mill dam and pond, centred on 292353 825925. The earth dam is c4m wide at base, flat top c1m wide, and slightly 'S' shaped. Depth 1m max, total length 40m. The pond which today is completely dry with a fine turf bottom is c 55m E/W x 28m with a narrow arm of 30m to the NW. The ditch / lade feeding the pond enters the pond at approx 15m W of the S end of the dam.	NH 9235 2592
LM23	Farmhouse	Fig 13	PL20-21	Modern farmhouse, stone and lime construction, 1.5 storeys with flat topped dormers, one collapsed in, at 292472 826091. Building rapidly falling derelict. Chimneys in both gables.	NH 9247 2609
LM24	Group of storage pits	Fig 12	PL12	Two storage pits. At 292456 826111. See scale drawing and photo PL12.	NH 9245 2611
LM25	Kerbed stance		PL11	A hard stance, with remains of stone kerbing c10 m to the W of the farmhouse.	NH 9245 2607
LM26	Group of storage pits	Fig 12	PL9	Group of 9 storage pits on a mound, at 292481 826065.	NH 9248 2606
LM27	Group of storage pits	Fig 16	PL13	Group of 3 storage pits in the face of the bank behind the timber range, at 292430 826051. The largest pit likely to be for neaps.	NH 9243 2605
LM28	Shieling hut and dairy	Fig 13	PL22	The scant heather covered footings of a shieling hut, at 292252 826004, 7m N/S x 2.5m internally. Possible pen attached to the S with a separate dairy c 2m x 1m internally, to the N, close a small un-named burn. A few stones show through the heather and turf.	NH 9225 2600
LM29	Possible round shieling hut		PL23	Oval feature cut into N facing slope of a moraine mound, at 292157 825900, c2m x 1.5m internally, may be part of the shieling group in this area.	NH 9215 2590
LM30	Round feature with lip		PL24	A sub-rectangular cut feature c3m N/S x 2m internally, and 0.4m deep cut into a small mound at 291161 825899, near the foot of a ditch.	NH 9215 2589
LM31a	Building	Fig 17	PL26-27	Building No1, possible long house, shown roofed on the 1st Ed OS, at 291938 826324, measures 16m E/W x 3m internally. Stone footings, spread to 2m in places, remain to c0.3m in ht. All covered in deep heather or turf. See scale drawing and photo PL26.	NH 9193 2632
LM31b	Longhouses	Fig 17	PL26-27	Possible long house. Building 2, smaller than Building 1 but of a similar nature, at 291958 826334, measures 5m N/S x 3m internally. Walls spread to c1m, remain to c0.4m high.	NH 9195 2633

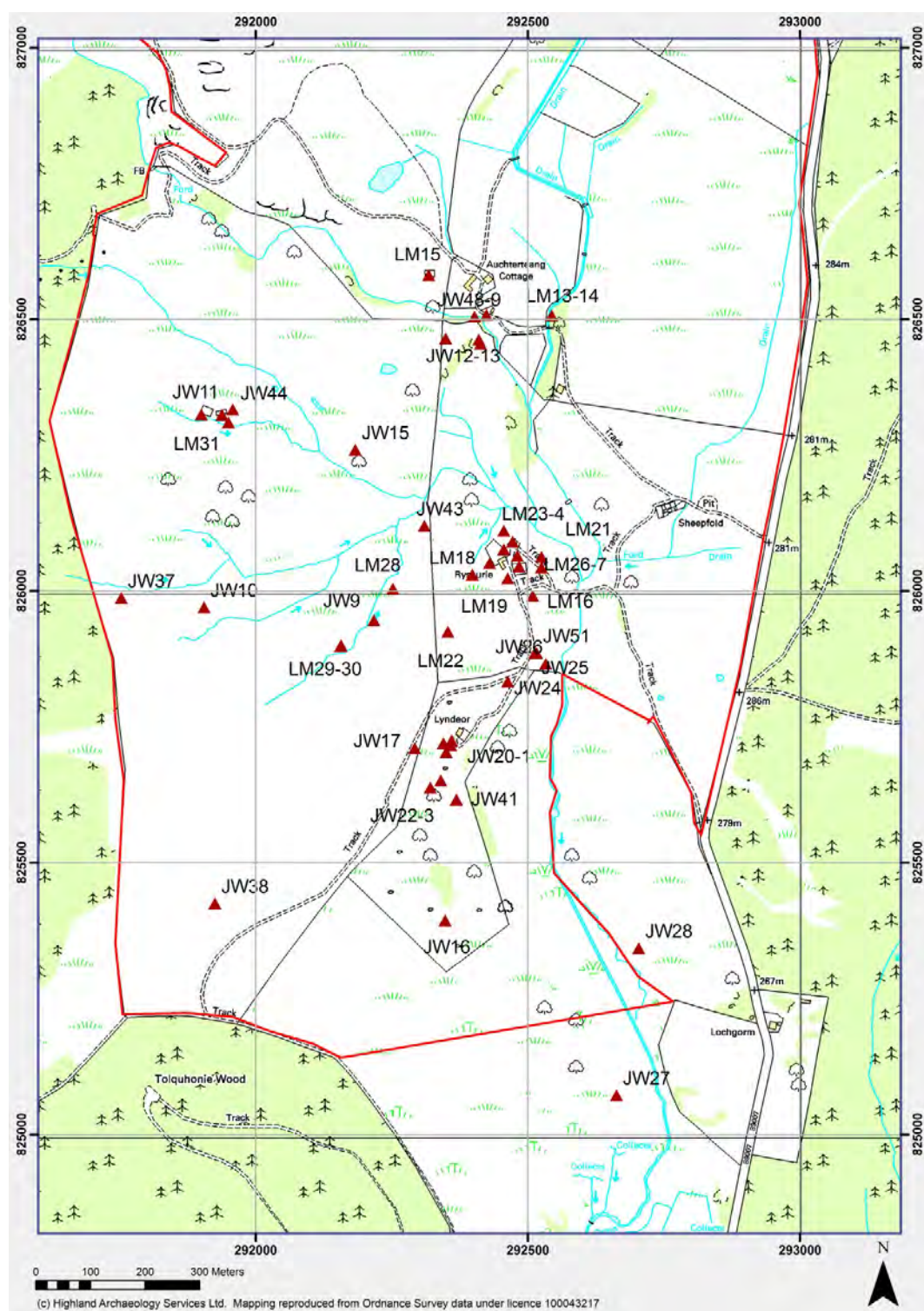

Figure 19 Site locations – Auchterteang and Lyndeor

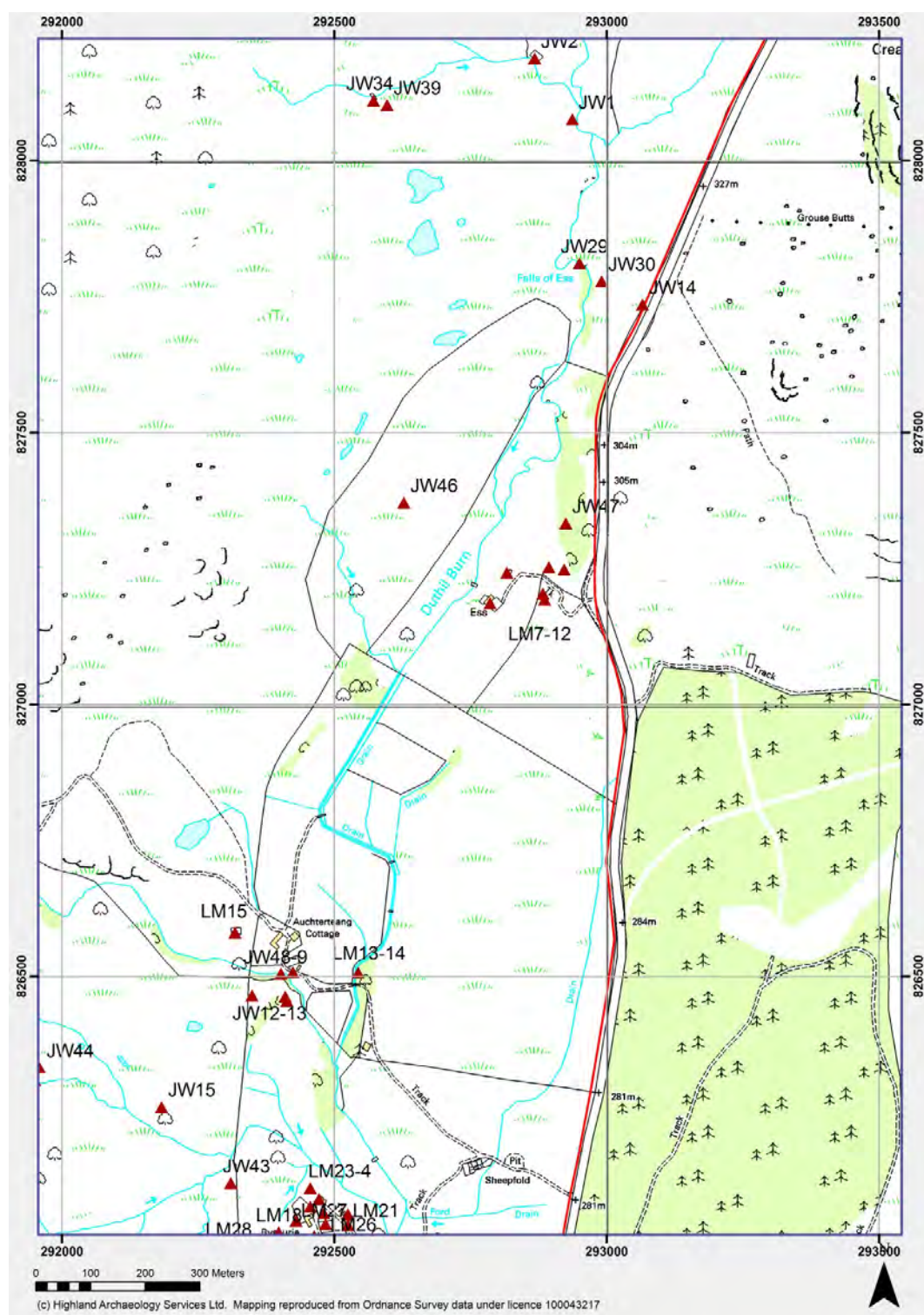

Figure 20 Site locations – Auchterteang north

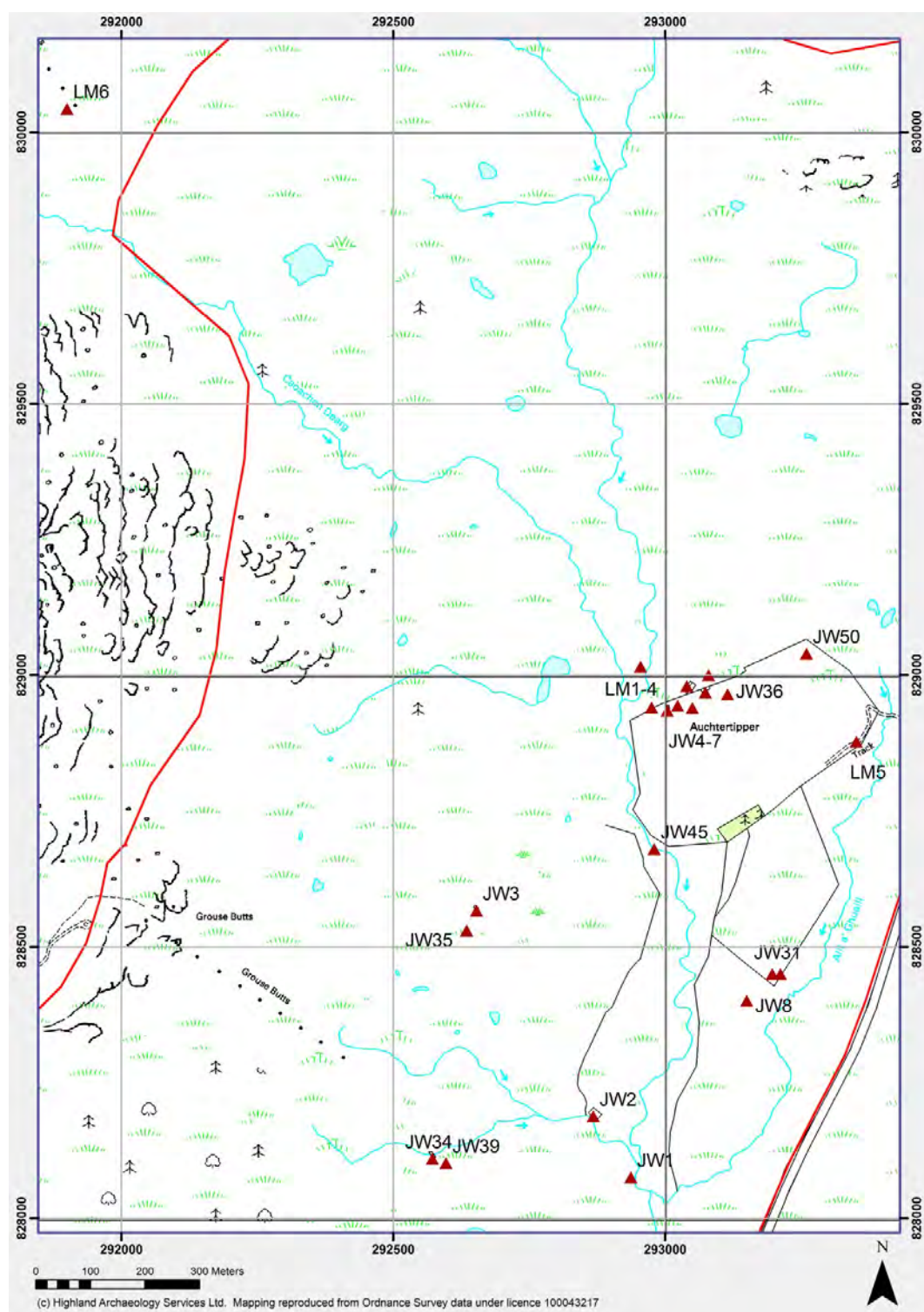

Figure 21 Site locations - Auchtertipper

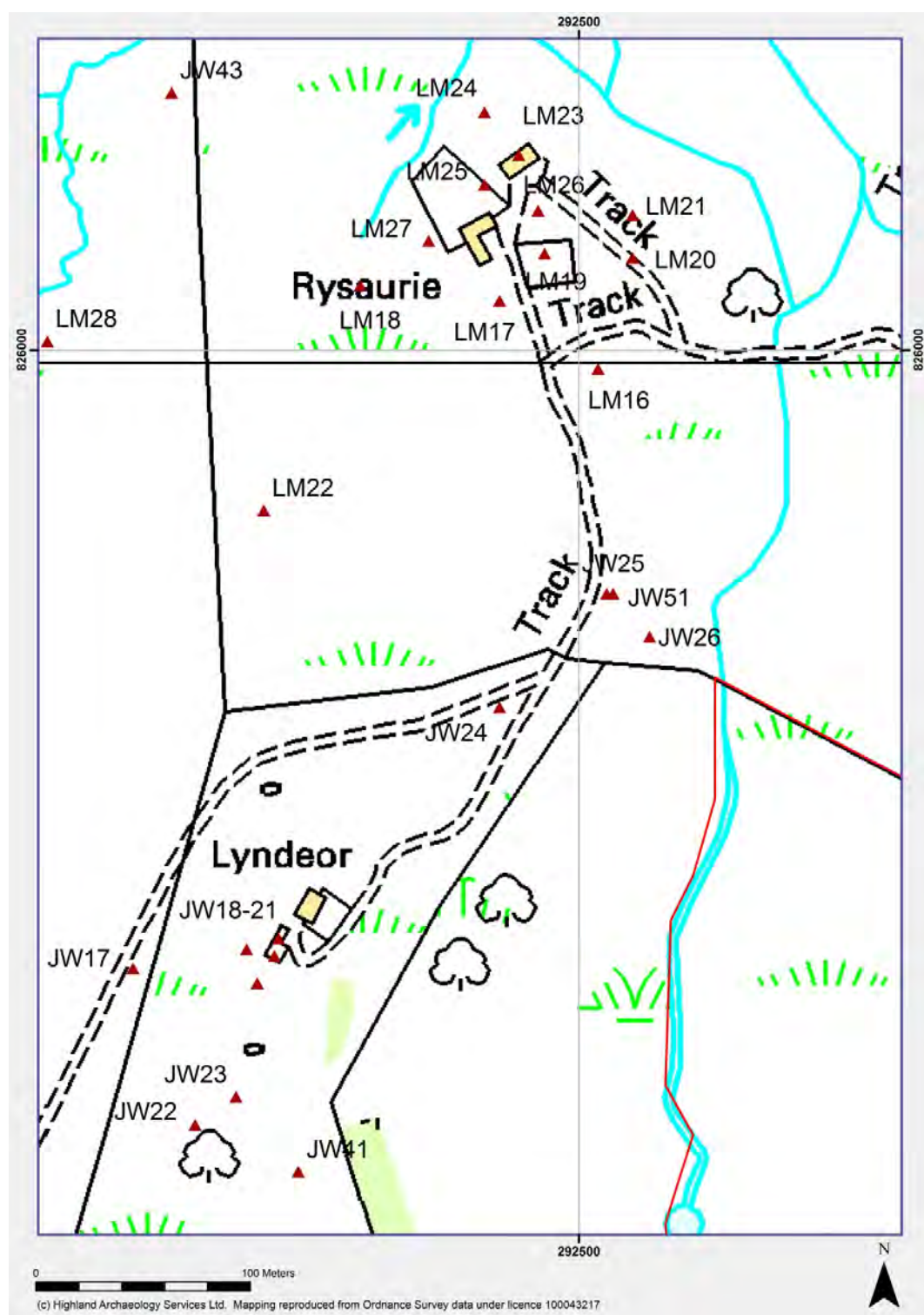

Figure 22 Site locations – Rysaurie / Lyndeor (detail)

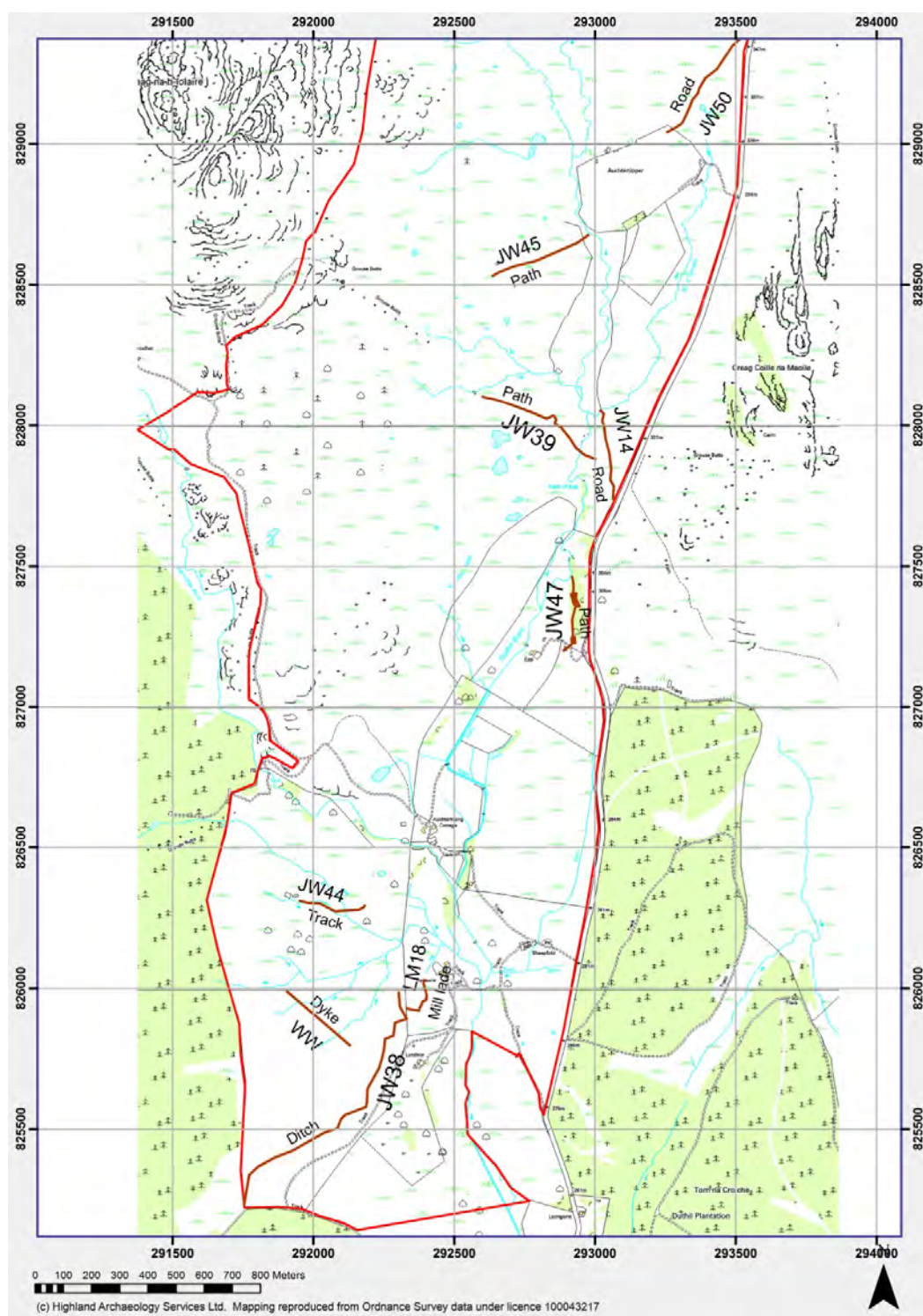

Figure 23 Linear features

APPENDIX 2: Index of Photographs

Photo Number	Features	Direction (facing)	Comments	Date	Taken by	NGR
PJ1	none	N	Shows ditch and turf wall	11/10/2010	JW	NH 9307 2847
PJ2	none	NNW	Shows ditch and turf wall	11/10/2010	JW	NH 9305 2840
PJ3	JW1	E	Small enclosure	11/10/2010	JW	NH 9293 2807
PJ4	none	NW	Shows ditch and turf wall	11/10/2010	JW	NH 9288 2808
PJ5	JW2	NE	Large enclosure poor photo	11/10/2010	JW	NH 9284 2815
PJ6	JW2	SE	Large enclosure good photo	11/10/2010	JW	NH 9285 2821
PJ7	none	NW	landscape	11/10/2010	JW	NH 9278 2835
PJ8	none	N	landscape	11/10/2010	JW	NH 9278 2835
PJ9	JW3	ESE	Corn drying kiln and barn on the moor	11/10/2010	JW	NH 9264 2857
PJ10	JW3	WNW	Corn drying kiln and barn on the moor	11/01/1900	JW	NH 9265 2856
PJ11	JW3	WNW	Corn drying kiln and barn on the moor	11/10/2010	JW	NH 9265 2856
PJ12	LM1	NW	Shieling hut near burn below farmstead	11/10/2010	JW	NH 9295 2900
PJ13	LM1	SE	Shieling hut with river defence wall	11/10/2010	JW	NH 9295 2902
PJ14	LM2	N	Long house, heather covered	11/10/2010	JW	NH 9295 2893
PJ15	JW4	WNW	Group of storage pits	11/10/2010	JW	NH 9300 2893

Photo Number	Features	Direction (facing)	Comments	Date	Taken by	NGR
PJ16	LM4	SE	Platform, ditch and possible rect footings	11/10/2010	JW	NH 9301 2896
PJ17	JW7	SSW	Corn kiln , barn and stack yard	11/10/2010	JW	NH 9301 2896
PJ18	LM3	ENE	Range in forefront, farmhouse to rear	11/10/2010	JW	NH 9301 2896
PJ19	JW5	W	Inside ruined farmhouse, west gable	11/10/2010	JW	NH 9307 2896
PJ20	JW7	E	Kiln bowl close-up	11/10/2010	JW	NH 9300 2893
PJ21	JW5	S	Inside ruined farmhouse, south wall	11/10/2010	JW	NH 9307 2896
PJ22	JW6	NE	Turf walled building	11/10/2010	JW	NH 9309 2897
PJ23	LM5	NNE	Lime kiln	11/10/2010	JW	NH 9334 2886
PJ24	LM5	NNE	Lime kiln close-up	11/10/2010	JW	NH 9334 2886
PJ25	none	N	unlikely circular feature	13/10/2010	JW	NH 9315 2839
PJ26	none	SE	landscape	13/10/2010	JW	NH 9266 3058
PJ27	none	S	landscape	13/10/2010	JW	NH 9266 3058
PJ28	none	SW	landscape	13/10/2010	JW	NH 9266 3058
PJ29	LM6	NW	Sample grouse butt (No 9 in this line)	13/10/2010	JW	NH 9190 3004
PJ30	none	NW	The wooden No 9 peg	13/10/2010	JW	NH 9190 3004
PJ31	none	E	Sample grouse butt	13/10/2010	JW	NH 9208 2856
PJ32	none	W	Sample grouse butt	13/10/2010	JW	NH 9210 2849
PJ33	none	NW	Sample grouse butt	13/10/2010	JW	NH 9225 2839
PJ34	none	ESE	landscape	14/10/2010	JW	NH 9262 2737
PJ35	LM10	N	Storage pits	14/10/2010	JW	NH 9292 2722

Photo Number	Features	Direction (facing)	Comments	Date	Taken by	NGR
PJ36	LM7	NE	Lime kiln	14/10/2010	JW	NH 9288 2719
PJ37	LM8	SE	Possible second kiln beside LM7	14/10/2010	JW	NH 9287 2719
PJ38	LM11		Carborundum sharpening stone	15/10/2010	LGJ	NH 9278 2718
PJ39	LM11		Hay rake	15/10/2010	LGJ	NH 9278 2718
PJ40	LM11		Use of heather in roof as insulation	15/10/2010	LGJ	NH 9278 2718
PJ41	LM11		Use of turf in roof as insulation	15/10/2010	LGJ	NH 9278 2718
PJ42	LM11		Use of turf in roof as insulation	15/10/2010	LGJ	NH 9278 2718
PJ43	LM11		Fireplace inside LM11	15/10/2010	LGJ	NH 9278 2718
PJ44	LM11		Corner press inside M11	15/10/2010	LGJ	NH 9278 2718
PJ45	LM11		Stalls inside LM11	15/10/2010	LGJ	NH 9278 2718
PJ46	LM11	W	Stone and lime range	15/10/2010	LGJ	NH 9280 2719
PJ47	LM11	NE	Stone and lime range	15/10/2010	LGJ	NH 9276 2717
PJ48	LM12	E	Ruined stone and lime building	40466	LGJ	NH 9280 7223
PJ49	LM13	NE	Lime kiln	15/10/2010	LGJ	NH 9254 2650
PJ50	JW12	ESE	Turf walled building	15/10/2010	JW	NH 9239 2647
PJ51	JW13	N	Small turf walled building	15/10/2010	JW	NH 9241 2644
PJ52	JW49	NE	Nissen hut on earlier stance	15/10/2010	JW	NH 9242 2650
PJ53	JW48	N	Stone walled enclosure	15/10/2010	JW	NH 9241 2650
PJ54	JW9	NE	Shieling hut and dairy	18/10/2010	JW	NH 9217 2594

Photo Number	Features	Direction (facing)	Comments	Date	Taken by	NGR
PJ55	JW10	E	Enclosure	18/10/2010	JW	NH 9190 2597
PJ56	JW16	E	Stone footings of a building	19/10/2010	JW	NH 9233 2538
PJ57	JW15	NNE	Stone footings of an 'L' shaped building	18/10/2010	JW	NH 9218 2626
PJ58	JW28	SE	Possible graves beside old track	19/10/2010	JW	NH 9270 2534
PL1	LM14	N	Longhouse footings	15/10/2010	LM	NH 9234 2645
PL2	LM15	S	East half of enclosure with pits beyond	15/10/2010	LM	NH 9232 2659
PL3	LM15	S	West half of enclosure	15/10/2010	LM	NH 9232 2659
PL4	LM16	N	Lime kiln	15/10/2010	LM	NH 9251 2597
PL5	LM19	NW	Kail yard / later kitchen garden	15/10/2010	LM	NH 9250 2601
PL6	LM19	NNW	Kail yard / later kitchen garden	15/10/2010	LM	NH 9250 2601
PL7	LM20	SE	Turf walled building truncated by track	15/10/2010	LM	NH 9256 2604
PL8	LM21	E	Small turf walled building	15/10/2010	LM	NH 9251 2605
PL9	LM26	ESE	Group of storage pits	15/10/2010	LM	NH 9247 2606
PL10	LM23	N	Farmhouse	15/10/2010	LM	NH 9247 2606
PL11	LM25	W	Kerbed stance	15/10/2010	LM	NH 9247 2606
PL12	LM24	SE	Group of storage pits	15/10/2010	LM	NH 9245 2611
PL13	LM27	E	Group of storage pits	15/10/2010	LM	NH 9241 2605
PL14	LM17	ENE	Back of timber range	15/10/2010	LM	NH 9242 2605

Photo Number	Features	Direction (facing)	Comments	Date	Taken by	NGR
PL15	LM18	NE	Stone built lade looking downhill from top	18/10/2010	LM	NH 9239 2602
PL16	LM18	WSW	Stone built lade looking uphill from bottom	18/10/2010	LM	NH 9241 2603
PL17	LM17	NW	Front of timber range	18/10/2010	LM	NH 9248 2605
PL18	LM22	S	Mill pond dam and lade intake in foreground	18/10/2010	LM	NH 9237 2594
PL19	LM22	N	Position of intake sluice gate	18/10/2010	LM	NH 9237 2592
PL20	LM23	W	Stove in farmhouse	18/10/2010	LM	NH 9247 2691
PL21	LM23	N	Hand pump	18/10/2010	LM	NH 9247 2609
PL22	LM28	NW	Shieling hut and dairy	18/10/2010	LM	NH 9227 2599
PL23	LM29	N	Possible round shieling hut	18/10/2010	LM	NH 9215 2589
PL24	LM30	SE	Round feature with lip	18/10/2010	LM	NH 9215 2589
PL25	JW11	SE	Enclosure	18/10/2010	LM	NH 9188 2633
PL26	LM31	W	Longhouse footings Building 1	18/10/2010	LM	NH 9295 2633
PL27	LM31	SW	Building 2	18/10/2010	LM	NH 9197 2634
PL28	LM17		Stalls inside LM17	19/10/2010	LM	NH 9246 2602
PL29	LM17		Date of 1903 on door inside LM17	19/10/2010	LM	NH 9246 2602
PL30	none	NE	Landscape	19/10/2010	LM	NH 9214 2514

Photo Number	Features	Direction (facing)	Comments	Date	Taken by	NGR
PL31	JW37	E	Weir JW37 to Lade JW38	19/10/2010	LM	NH 9176 2531
PL32	JW38	S	Weir JW37 to Lade JW38	19/10/2010	LM	NH 9277 2531
PL33	JW17	E	2 structures above hill gate	19/10/2010	LM	NH 9228 2571
PL34	JW23	SE	Enclosure	19/10/2010	LM	NH 9232 2566
PL35	JW22	W	Lime kiln	19/10/2010	LM	NH 9233 2563
PL36	JW18	NW	Ruins of 19thC building, demolished	19/10/2010	LM	NH 9233 2569
PL37	JW19	SW	Timber bothy, hen house and hen run	19/10/2010	LM	NH 9237 2572
PL38	JW20	NE	Timber garage inserted into 19thC ruin	19/10/2010	LM	NH 9235 2573
PL39	JW21	N	20thC farmhouse	19/10/2010	LM	NH 9238 2572
PL40	JW24	SE	Group of storage pits and an oval stance	19/10/2010	LM	NH 9246 2583
PL41	JW25	E	Group of storage pits	19/10/2010	LM	NH 9251 2588
PL42	JW29	SW	Wooden dam above Ess falls	20/10/2010	LM	NH 9295 2781
PL43	JW29	NW	Face of dam above Ess falls	20/10/2010	LM	NH 9295 2780
PL44	JW30	E	Sample unlined grouse butt disused	20/10/2010	LM	NH 9299 2777
PL45	JW14	E	Old road from above Ess falls to Auchtertipper	20/10/2010	LM	NH 9304 2779

Photo Number	Features	Direction (facing)	Comments	Date	Taken by	NGR
PL46	JW14	N	Old road from above Ess falls to Auchtertipper	20/10/2010	LM	NH 9305 2778
PL47	JW36	W	Lochans / ponds in front of farmhouse	20/10/2010	LM	NH 9316 2896
PL48	JW32	SE	Sample grouse butt, Garrocher Burn	20/10/2010	LM	NH 9180 2729
PL49	JW40		Inside Garrocher Lunching Hut	20/10/2010	LM	NH 9132 2826
PL50	JW40	N	Outside Garrocher Lunching Hut	20/10/2010	LM	NH 9133 2825
PL51	none	N	Sample grouse butt	20/10/2010	LM	NH 9169 2831
PL52	none	NE	Landscape	20/10/2010	LM	NH 9194 2852
PL53	none	E	Landscape	20/10/2010	LM	NH 9194 2852
PL54	none	S	Landscape	20/10/2010	LM	NH 9194 2852
PL55	JW34	N	Footbridge (derelict)	40471	LM	NH 9257 2810



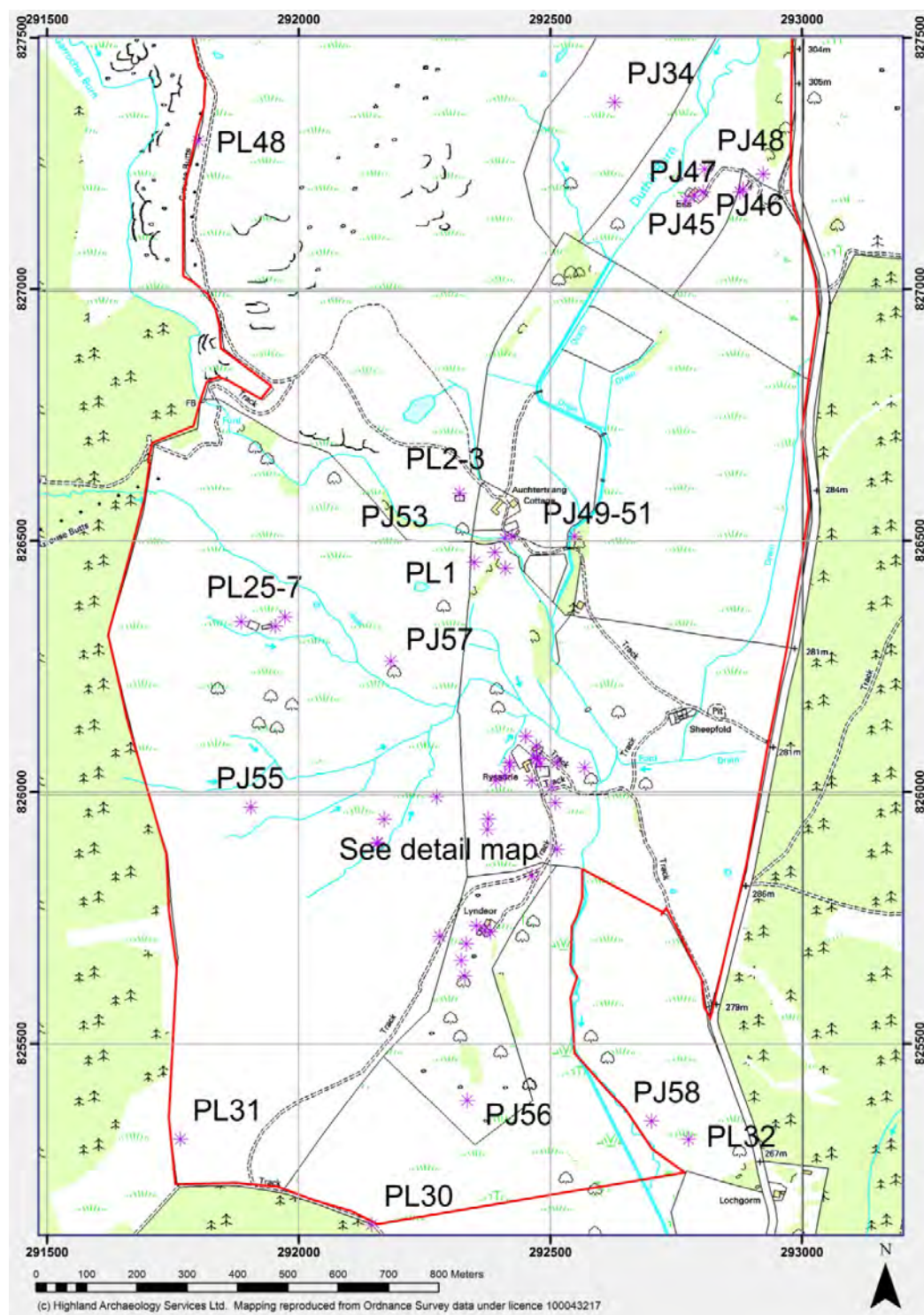

Figure 25 Photo locations (S)

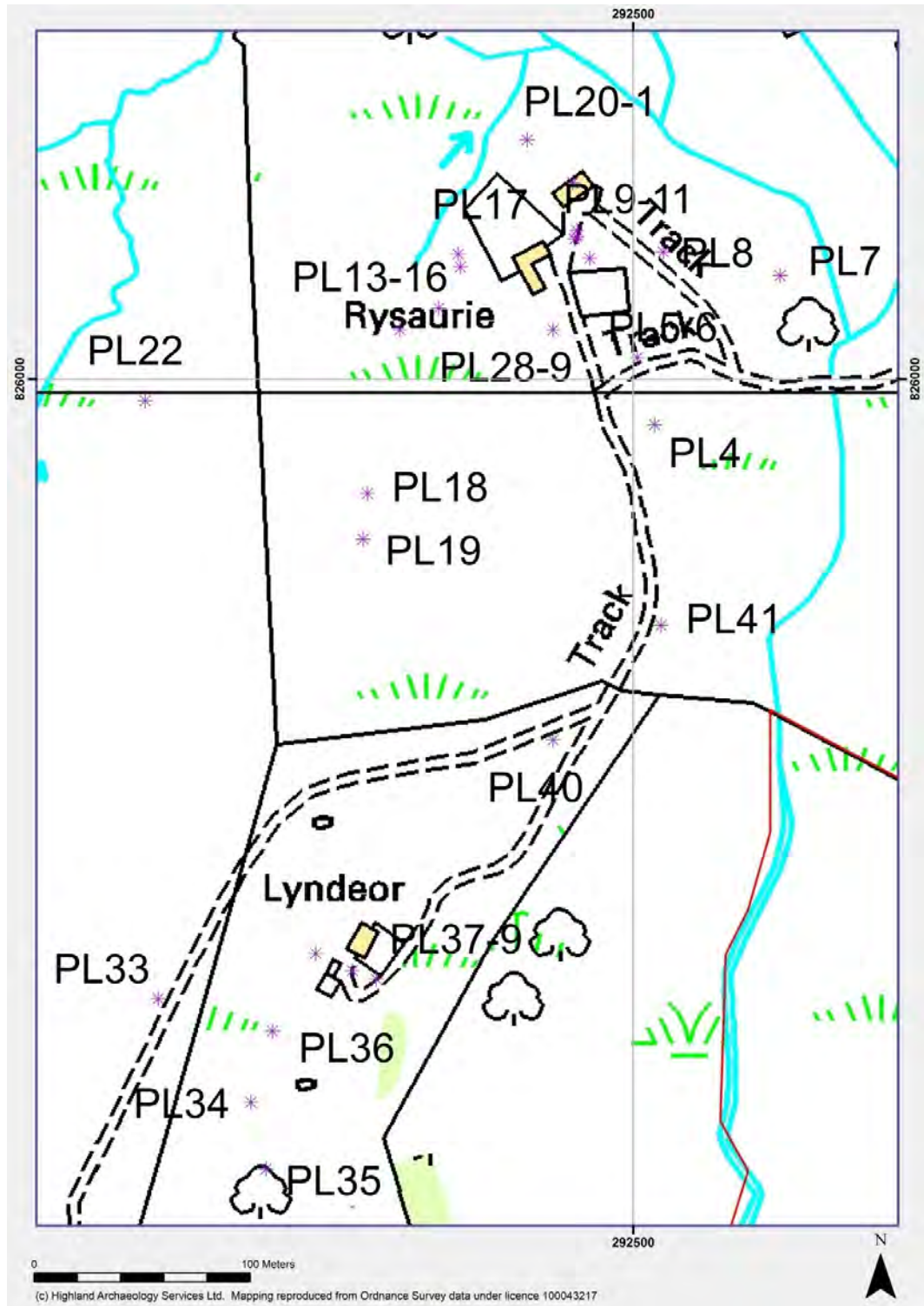

Figure 26 Photo locations – Rysaurie / Lyndeor (detail)