

**Report of Archaeological Evaluation**  
**April 23<sup>rd</sup> 2001**  
**Strath, by Gairloch, Highland**  
**NH 7985 / 7735**

**By**  
**Stuart Farrell**  
**B.A A.I.F.A F.S.A.Scot.**  
**April 2001**

## Introduction

This report is for an evaluation conducted on behalf of The Highlands Small Communities Housing Trust by the author for a small housing development at Strath, by Gairloch.

## Acknowledgements

I would like to thank the following for their help during the work :

- Mr. R Phillips, of The Highlands Small Communities Housing Trust ;
- Staff of MacLeod & Mitchell (Contractor's) Ltd for onsite works;
- Staff of the Highland Council Archives;
- Staff of Highland Council Archaeology Unit.

## Site Location



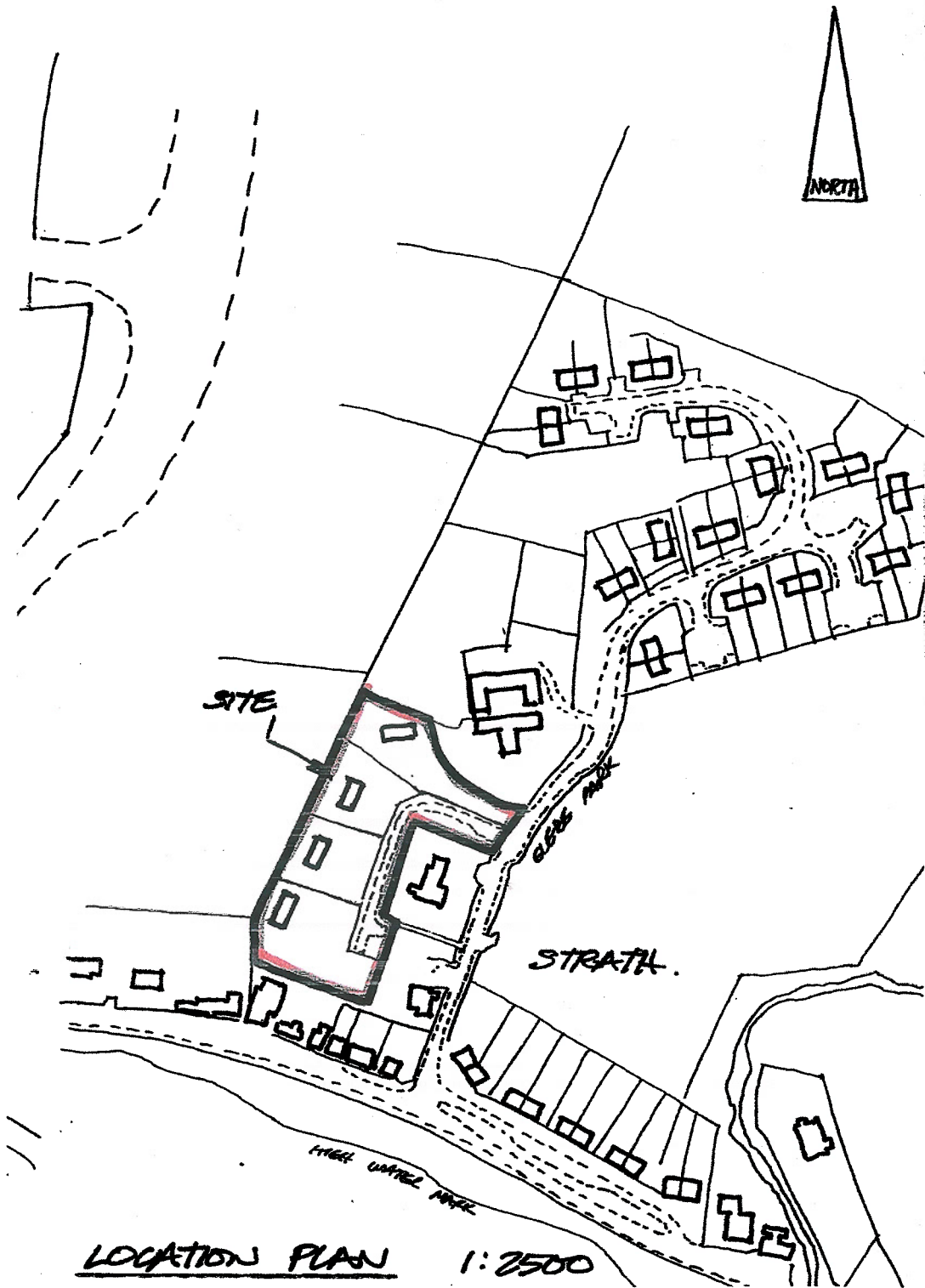

LOCATION PLAN

1:2500

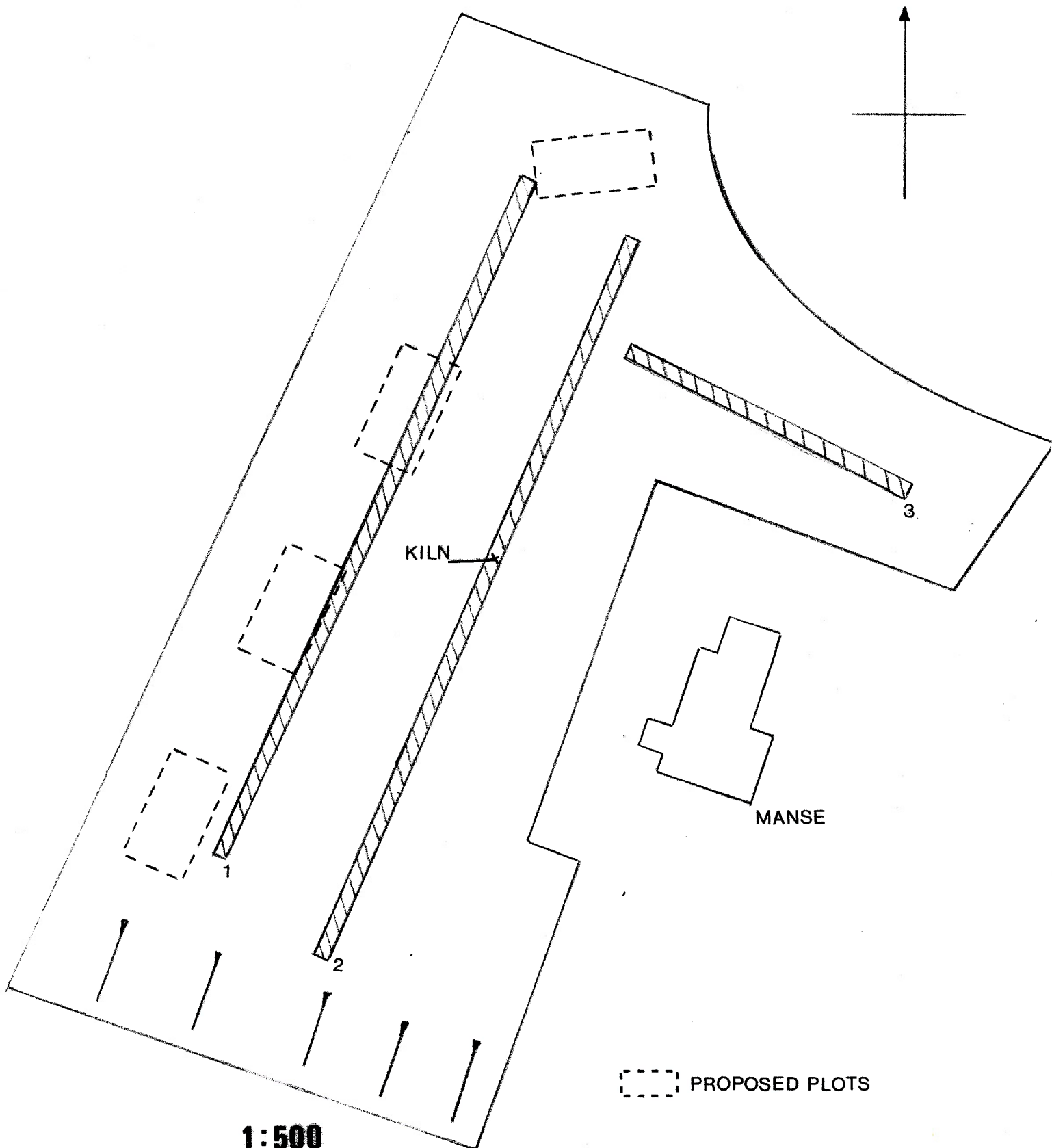



### **Historical Background**

The area of the development lies to the centre of the village of Strath. Currently no archaeological sites are located in the development area. Though a number of sites are located nearby and are currently listed in the Highland Council Sites and Monuments Record and the National Monuments Record of Scotland CANMORE database as follows:

- NG77NE 1 – Symbol stone at NH 7997/7721 – Found in this area before 1871 of a 7<sup>th</sup>/8<sup>th</sup> century date – now in Gairloch Museum. A long cist burial of a female was found c.230 yards SE of Gairloch Manse in October 1949. Three other burials were found c.200 yards further south at NH 8012/7703 when the Free Presbyterian Church was built in 1896.
- NG77NE 9 – Gairloch Manse at NH 7980/8774 – house of 1805 (listed building)
- NG87NW 1 – Carn Mor Cairn at NH 8007/7702 – named in OS name book of 1875.

There is no information on the site in the Highland Council Archives.

There is nothing indicated on the 1<sup>st</sup> edition of the OS map of 1872.

A study of aerial photographs held in the Highland Council Sites and Monuments Record revealed no archaeological features to be visible in the period 1946-47, the area of development formerly being under pasture.

### **Objectives**

To conduct an evaluation of 5% on the area of development and to record those features revealed by excavation work. A copy of the specification provided by Highland Council Archaeology Unit is enclosed.

## **Trial Trenching Investigation**

### **Methodology**

The trial trenching was carried out in accordance with accepted professional archaeological standards as published by the Institute of Field Archaeologists (IFA 1999). Over the period of the ground works a suitably qualified archaeologist was on site to carry out observations and assessment of the trenches made by the excavation works.

### **Site Conditions**

The area under investigation is an area of rough pasture ground, and forms an L-shaped piece of ground. Weather on the day of work (April 23<sup>rd</sup> 2001) was overcast with slight showers.

### **Results**

An inspection of the area of excavation centred at NH 7985 / 7735 showed no features prior to excavation. The only feature was the remains of stone wall to the top of the embankment, showing that the area had formerly been enclosed.

Underlying the turf and topsoil of an average depth of 120mm was a natural of orange-brown silty gravels (some of the gravel being quite large and rounded).

A total of 3 trench's totalling 264 m<sup>2</sup> were machine excavated, relating to proposed plots and access roads, being 5% of the development area of 5260m<sup>2</sup> or 1.3 acres.

The only archaeological feature revealed during the course of excavations was the remains of a small corn-drying kiln in trench 2. (See figure 1 and photographs 1 & 2) This was c.90cm in diameter and utilised part of a natural mound for its construction, and was comprised of small to medium stones set on the ground. There were only slight signs of firing upon the stones themselves and on the natural ground surface. A small sherd of white glazed pottery was found upon cleaning (not retained), along with some burnt barley.

It is likely that this corn-drying kiln is associated with the nearby ruined croft c.200m NNW from the site and dates to the early 19<sup>th</sup> century.

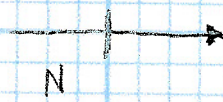

1:10

EDGE OF  
TRENCH

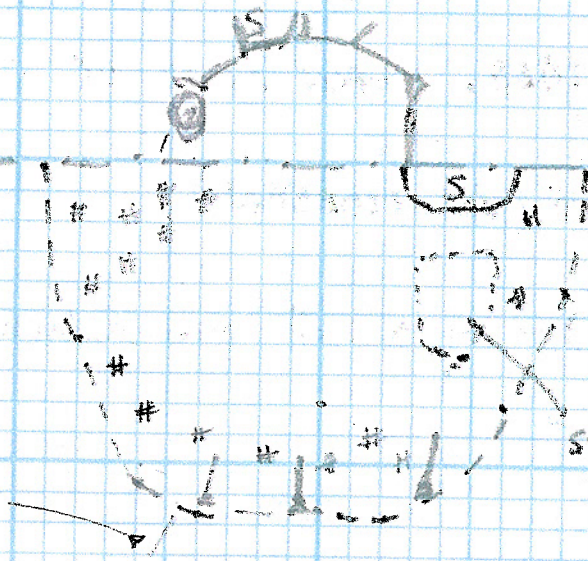

EXTENT OF  
'CHARCOAL' SPREAD

STONE HOLE

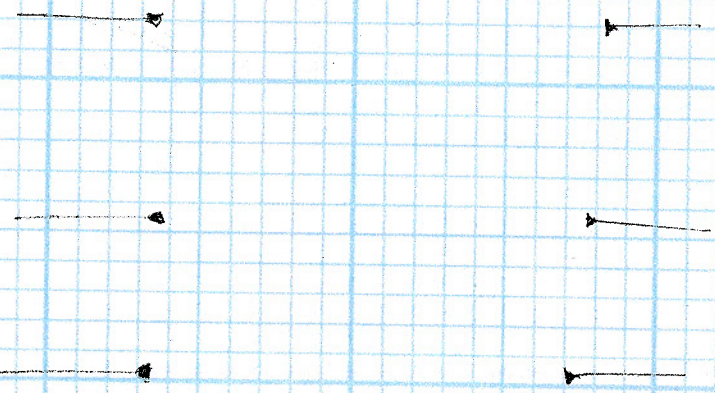



Top – View of kiln facing West.  
Bottom – ibid.

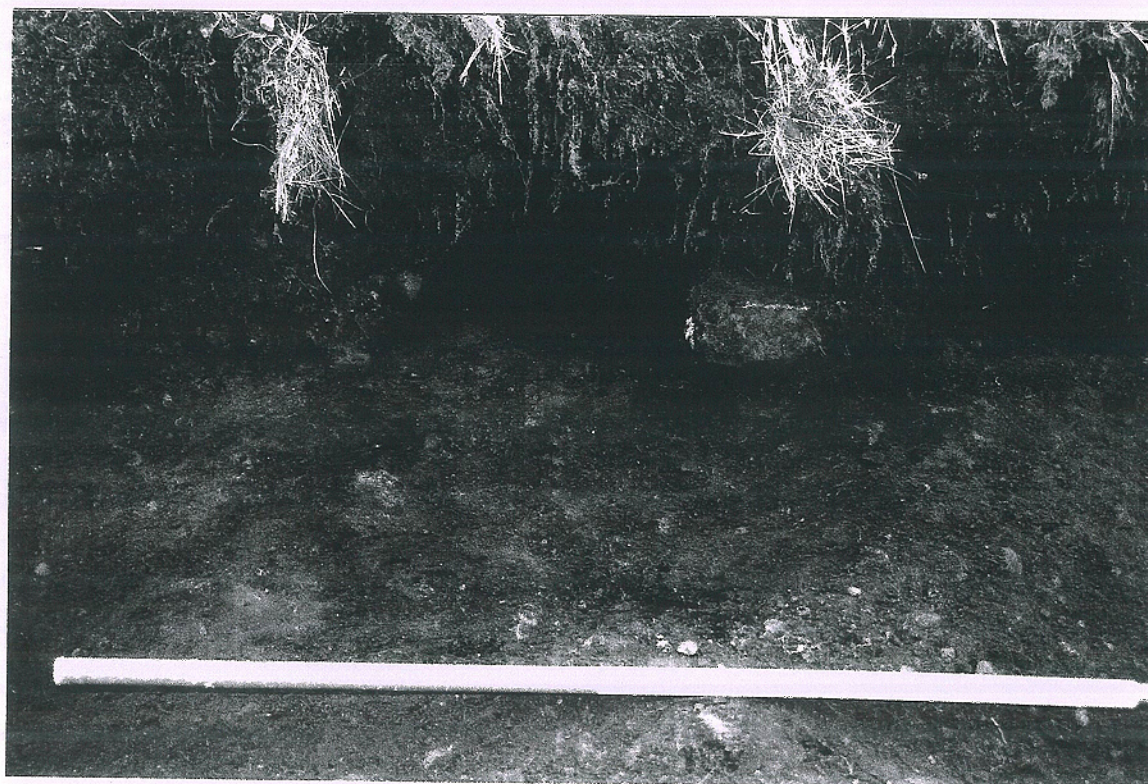
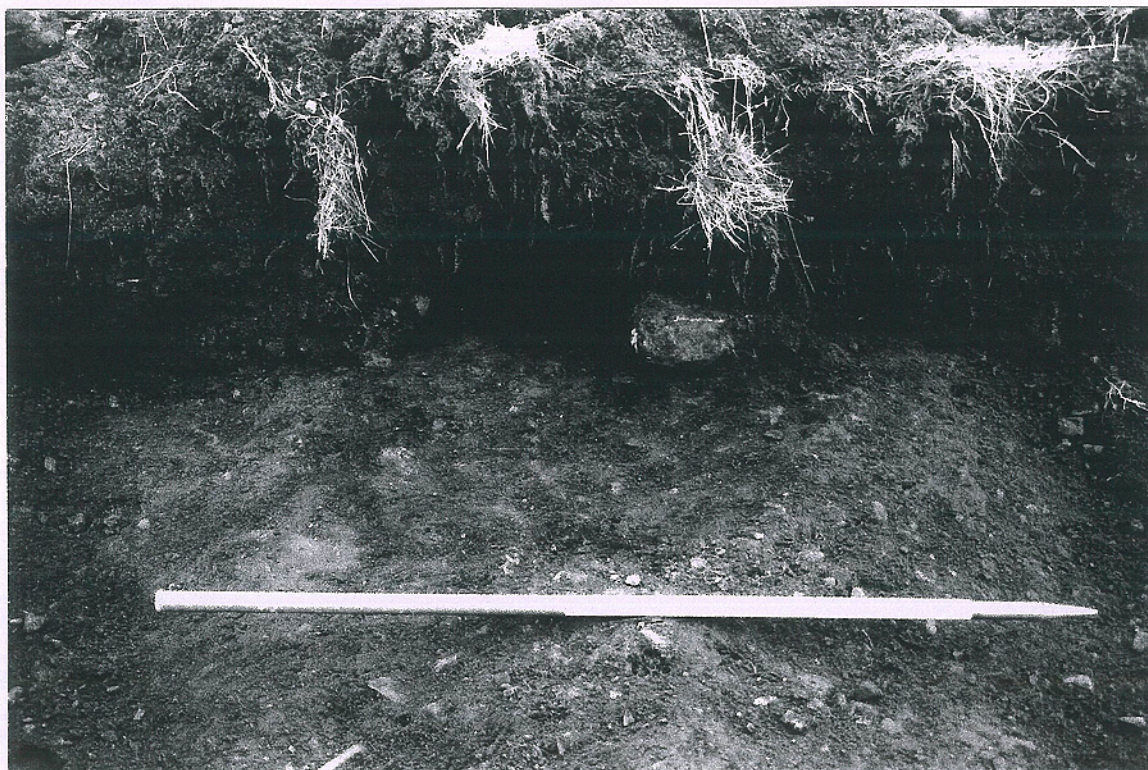



### **Recommendations**

No recommendations with regards to this development project are to be proposed.

### **Archive**

Notebook of results will be deposited in the National Monuments Record of Scotland in Edinburgh. A set of colour slides detailing the work has been deposited with Highland Council Sites and Monuments Record.

### **References**

Gifford, J. (1992) *The Buildings of Scotland : Highlands and Islands*. Penguin. London.

Highland Sites and Monuments Record database entries NH77NE 1 & 9, NG87NW 1 & 51.

IFA (1999) *By-laws, Standards and Policy Statements of the Institute of Field Archaeologists*. Reading.

National Monuments Record of Scotland CANMORE entries NH77NE 1 & 9, NG87NW 1 & 41.

Stevenson, R B K (1954) 'Long cist burials, particularly those at Galson (Lewis) and Gairloch (Wester Ross), with a symbol stone at Gairloch'. *Proc Soc Antiq Scot*, 86, 1951-2, 106 – 115.

### Aerial Photographs Consulted (Highland SMR)

1946 – CPE/Scot/UK 183 8 Oct 46 (1267)

Stuart Farrell  
39a Park Street  
Nairn  
Highland  
IV12 4PP

## **Appendix 1 – Details of Slides**

Slides have been deposited with Highland Council Sites and Monuments Record, Inverness.

1 – View of site facing south	23-4-01
2 – View of site access facing east	23-4-01
3 – View of site facing north	23-4-01
4 – View of machining of trench 1 facing north	23-4-01
5 – View of trench 1 upon completion facing north	23-4-01
6 – View of corn drying kiln upon initial cleaning facing west	23-4-01
7 – ibid	23-4-01
8 – ibid	23-4-01
9 – View of trench 2 facing north	23-4-01
10 – View of trench 3 upon completion facing west	23-4-01
11 – View of corn drying kiln upon cleaning facing west	23-4-01
12 – ibid	23-4-01
13 – View of corn drying kiln upon excavation	23-4-01

## **Appendix 2 – Details of Black & White Photographs**

1 – View of corn drying kiln facing West. Scale 1m.	23-4-01
2 – Ibid.	23-4-01
3 – Ibid.	23-4-01
4 – Ibid.	23-4-01

## **Appendix 3 – Details of Trenches**

1 – 1.6m x 72m – topsoil depth 150mm
2 – 1.6m x 76m – topsoil depth 150mm
3 – 1.6m x 30m – topsoil depth 200mm



**Specification for archaeological work at:**

**Glebe Park, Gairloch**

**ARCHAEOLOGICAL EVALUATION**

**HIGHLAND COUNCIL  
PLANNING AND  
DEVELOPMENT SERVICE**

**Archaeology Unit**

## **1. Background**

This specification has been produced in response to the need for an archaeological evaluation to be carried out prior to work beginning on site. It is for a minimum standard of work; a higher standard may be offered and accepted.

## **2. Terms of Reference**

This specification is for archaeological recording work occasioned by planning application no. 01/00126/OUTRC. It is based on these documents. If these details are changed a new specification will be needed. It is valid until 1<sup>st</sup> March 2002 after which if no work has been carried out a revised specification will be needed.

The specification has been produced for the applicant who will be responsible for the work, including all tendering and contractual arrangements. Estimates should be obtained from archaeological contractors on the basis of this specification

Any reference to 'archaeologist' in this specification is to be taken to mean a qualified and experienced practitioner acceptable to the Senior Archaeologist. This is to ensure that work is carried out to professional standards. The project should be carried out by, or under the immediate direction of, a member of the Institute of Field Archaeologists or an archaeologist of equivalent standing.

**Before site works commence, the proposed arrangements, including a timetable for the work must be agreed with the Area Planning Manager and the Senior Archaeologist in writing.**

If this is for a road or water or sewerage proposal the area to be covered is the entire wayleave except where otherwise indicated.

## **3. Tendering**

Tenders must be accompanied by a project design, statement and evidence of competence, including the CV of the Project Director, and other staff where possible.

## **4. Objectives**

1. To establish the presence/absence, nature depth extent and importance of previously unrecorded and recorded archaeological remains
2. To propose arrangements for the safeguarding where possible and recording where necessary of any archaeological features or finds identified. These will be approved by the Senior Archaeologist.
3. To ensure that the needs for archaeological conservation and recording are met without causing any unnecessary delay or disturbance to the development project.

## **5. Method**

- A desk based assessment of the site, to include consultation of at least; *The Highland Council Sites and Monuments Record, The Highland Council Archive, The National Monuments Record, any locally held private archives, Aerial Photographic coverage*
- A survey will be made of the areas identified on the attached plan, using a walk over survey of the area to enable identification of any upstanding remains, from any period, including modern. All individual features to be recorded on a 1:2500 plan.
- Trial trenches will be excavated at locations to be proposed to provide a sample of the total site area. A sample of at least 5% of the area must be evaluated. The location of these trenches must be accurately located on the aforementioned 1:2500 plan.
- Those carrying out site works will need to work closely with the archaeologist and provide all necessary access and other arrangements. Where machinery is to be used for topsoil stripping, a straight-edged bucket must be used on a back acting machine. Care will need to be taken to avoid over excavation, and the advice of the archaeologist on-site should be adhered to regarding this.



- The archaeologist must be given every aid by contractors to enable the archaeological work to be carried out. Contractors may need to use differing work practices on site than usual to enable the archaeologist to complete the work. This must be catered for and adhered to.
- The report must propose appropriate arrangements for the safeguarding where possible or recording where necessary of any objects or features identified by this evaluation.

## **6. Monitoring**

- I. The Senior Archaeologist will normally monitor projects to ensure that specifications are met.
- II. Monitoring will normally be by unannounced site visit. Alternative or additional monitoring arrangements may be made in individual cases.
- III. Prior notice of fieldwork starting dates, with contact names and local addresses, telephone numbers and directions and other arrangements for access must be given to the Area Planning Manager and the Senior Archaeologist.
- IV. Any unexpectedly significant or complex discoveries, or any other unexpected occurrences or conditions which might affect the agreed project work or its timetable or cost must be notified immediately to the client and the Senior Archaeologist so that revised arrangements can be made.
- V. Where archaeological work fails to meet this specification the applicant will be in breach of the planning condition until matters are rectified.

## **7. Reporting**

### **Project report**

At least five copies of the project report must be produced.

- I. One paper copy for the applicant.
- II. One paper copy for the Area Planning and Building Control Manager
- III. One paper copy for the Archaeology Unit, Planning and Development Service, Council Offices, Glenurquhart Road, Inverness IV3 5NX where it will be available for immediate consultation by the public.
- IV. One copy for the Highland SMR as above, on a computer disk in a format compatible with Microsoft Office 95 for Windows.
- V. One paper copy to be deposited with Norman Newton, Libraries Support Unit, 31a Harbour Road, Inverness.

**The report must be submitted to the all of the above within 2 weeks of the completion of the field work.**

The report must include, as a minimum,

1. Location plan showing the project area and archaeological sites and features affected. The Grid Reference of the site must be included.
2. Circumstances and objectives of this work, including a copy of this specification

3. Weather and other conditions affecting fieldwork
4. Scale plans, and photographs of geophysical grids, trial trenches and archaeological features noted. The scale plans must accurately locate the grids and trial trenches within the development area.
5. A full index to any records or other material generated by the project including its location
6. Details of any measures proposed to mitigate the impact of the application on the archaeological resource
7. A brief analysis of the project results drawing in comparative data as appropriate, and a statement of the significance of the results for future research. Note that a negative result may itself be significant.
8. General comments and proposals for future archaeological projects arising from the carrying out of this project
9. A set of colour slides illustrating the project progress from start to completion.

The completed report will be available for immediate public consultation for research purposes at the Highland Sites and Monuments Record. In addition, the Archaeology Unit reserves the right to make the report available for reference and research purposes, either on paper, or electronically. Subject to this, copyright will remain with the author unless specifically transferred in writing, and the Archaeology Unit will assume author's copyright unless advised otherwise. Copyright will be acknowledged in all cases by the Archaeology Unit.

This specification includes arranging a presentation of the project results to the local community within a year of the completion of the fieldwork. Arrangements must be agreed with the Senior Archaeologist.

## **8. Treasure Trove**

The Archaeological Contractor must liaise with the Assistant Curator (Archaeology) at Inverness Museum and Art Gallery prior to the start of fieldwork, regarding possible emergency conservation needs and future storage arrangements. The Assistant Curator will in turn notify the local museum of the fact that there is archaeological work ongoing in the area. Should museum staff wish to visit the site whilst the archaeological work is in progress, they must first gain permission from the site owner/agent. The site owner/agent must be aware that no one, other than the Council's Planning Officer, in consultation with the Archaeology Unit, has the authority to vary the terms of this specification.

Provision must also be made for a cataloguing system for artefactual material, which will be compatible with the needs of the institution receiving these finds. Any report to the Queen's and Lord Treasurer's Remembrancer must be copied to the Senior Archaeologist, and the Assistant Curator (Archaeology) at Inverness Museum and Art Gallery. Any finds, where appropriate, should also be reported to the Receiver of Wreck.

## **9. Discovery and Excavation in Scotland**

A brief summary of the results must be sent to the Council For Scottish Archaeology for inclusion in Discovery and Excavation in Scotland. The cost of this must be included in any tender document.

## **10. General**

1. The archaeologist appointed must be of a professional standing acceptable to the Senior Archaeologist and must carry out the work according to the Code of Conduct, standards and guidelines of the Institute of Field Archaeologists.



2. The main contractor has responsibility for the Health and Safety of any archaeological staff on site.
3. The archaeologist is responsible for taking all necessary measures to conform with the Health and Safety at Work Acts and be covered by all necessary insurances.
4. Any Health and Safety incidents on site involving the archaeologist must be immediately notified to the Health and Safety Executive.
5. The archaeologist must agree a timetable for the work with the client and the Senior Archaeologist
6. The archaeologist appointed will not comment to the press or other media without prior approval from the Senior Archaeologist
7. Proper provision must be made for prevailing weather conditions in northern Scotland
8. The archaeologist agrees by undertaking this work to the terms of this specification.

9.

Dorothy M Low

Wednesday, 21 February 2001

